

Технические характеристики

По вопросам продаж и поддержки обращайтесь:

Алматы (7273)495-231	Казань (843)206-01-48	Новокузнецк (3843)20-46-81	Смоленск (4812)29-41-54
Архангельск (8182)63-90-72	Калининград (4012)72-03-81	Новосибирск (383)227-86-73	Сочи (862)225-72-31
Астрахань (8512)99-46-04	Калуга (4842)92-23-67	Омск (3812)21-46-40	Ставрополь (8652)20-65-13
Барнаул (3852)73-04-60	Кемерово (3842)65-04-62	Орел (4862)44-53-42	Сургут (3462)77-98-35
Белгород (4722)40-23-64	Киров (8332)68-02-04	Оренбург (3532)37-68-04	Тверь (4822)63-31-35
Брянск (4832)59-03-52	Краснодар (861)203-40-90	Пенза (8412)22-31-16	Томск (3822)98-41-53
Владивосток (423)249-28-31	Красноярск (391)204-63-61	Пермь (342)205-81-47	Тула (4872)74-02-29
Волгоград (844)278-03-48	Курск (4712)77-13-04	Ростов-на-Дону (863)308-18-15	Тюмень (3452)66-21-18
Вологда (8172)26-41-59	Липецк (4742)52-20-81	Рязань (4912)46-61-64	Ульяновск (8422)24-23-59
Воронеж (473)204-51-73	Магнитогорск (3519)55-03-13	Самара (846)206-03-16	Уфа (347)229-48-12
Екатеринбург (343)384-55-89	Москва (495)268-04-70	Санкт-Петербург (812)309-46-40	Хабаровск (4212)92-98-04
Иваново (4932)77-34-06	Мурманск (8152)59-64-93	Саратов (845)249-38-78	Челябинск (351)202-03-61
Ижевск (3412)26-03-58	Набережные Челны (8552)20-53-41	Севастополь (8692)22-31-93	Череповец (8202)49-02-64
Иркутск (395)279-98-46	Нижний Новгород (831)429-08-12	Симферополь (3652)67-13-56	Ярославль (4852)69-52-93
Россия (495)268-04-70	Киргизия (996)312-96-26-47	Казахстан (7172)727-132	

Series overview

SPEEDTEC®

UP TO
-20G-
VIBRATION-RESISTANT

locktec

EMV/EMC



IP 66/67

UL US

Series	Type	Special characteristics	Number of positions	Connector Style										Page
				Plug (ST)	Angled Plug (SD)	Extension (KV)	Angled Extension	Receptacle (EG)	Angled Receptacle (EW)	Rotatable, Angled Receptacle (ED)	Rotatable, Angled Twin Receptacle (ED)	Bulkhead Connector (DF)		
615			12, 15	■		■								
615		itec	12, 15							■				
615		ytec	15 + M12								■			
615		minitec	7	■				■						
615		locktec	12, 15	■		■								
915			9	■		■								
915		itec	9							■				
915		ytec	9 + 12								■			
915		locktec	9	■		■								
617	M17		12, 17	■		■		■		■				
617	M17	speedtec	12, 17	■		■		■		■				
617	M17	locktec	12, 17	■		■								
917	M17		4, 7, 9	■		■		■		■				
917	M17	speedtec	4, 7, 9	■		■		■		■				
917	M17	locktec	4, 7, 9	■		■								
917	M17	singletec	1	■		■		■						
623	M23	size 1	6, 7, 8 + 1, 9, 12, 17, 16 + 3	■	■	■	■	■	■	■	■	■	■	
623	M23	speedtec	6, 7, 8 + 1, 9, 12, 17, 16 + 3	■	■	■	■	■	■	■	■	■	■	
623	M23	locktec	6, 7, 8 + 1, 9, 12, 17, 16 + 3	■		■								
623	M23	twintec B	15 + 4	■		■		■						
923	M23	size 1	6, 8, 9	■	■	■		■	■	■		■		
923	M23	speedtec	6, 8, 9	■	■	■		■	■	■		■		
923	M23	locktec	6, 8, 9	■		■								
923	M23	singletec	1	■		■		■						
723	M23	h-tec	11, 10	■		■		■	■	■				
627		26-pin	26	■		■		■						
932		twintec	18, 23, 25	■	■	■		■	■			■		
932		twintec 2	19, 24, 26	■		■		■	■			■		
940	M40	size 1.5	6, 8, 9	■	■	■	■	■	■	■		■		
940	M40	size 1.5	speedtec	6, 8, 9	■	■	■	■	■	■		■		
958		size 3	6, 8	■		■		■	■					
Crimping tools													24	
Motor, Servo and Feedback Cables – the enhanced TOPSERV® family													26	

Product Key

In this brochure you will find the corresponding key codes to construct and order your connector.

B S T A 0 7 8 N N 0 0 4 2 0 2 3 5 3 0 0

Series:
e.g.:
B = Series 923:
power M23

Housing Surface:
e.g.:
A = nickel plated

Contacts:
Internal code
NN 00 = Pins not included in product key. Please select and order separately.

Design Variation:
Internal code

Packaging:
Internal code

Housing:
ST = plug
Additional Configurations
SD, KU, EG, EW, ED, DF

-> see Series Overview

Insulation Inserts:
Internal code

Cable Clamp:
Internal code
For bulkhead connectors, receptacles and angled receptacles, corresponding field is marked "00".

Plug

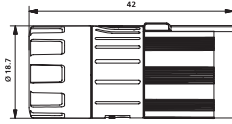

Plug
 with lock fastener for automatic locking

Product key
E S T [] [] [] [] [] [] [] [] [] [] [] [] **0 0 0 1 3 0 0**
B plastic coated

Insulation Inserts and Contacts

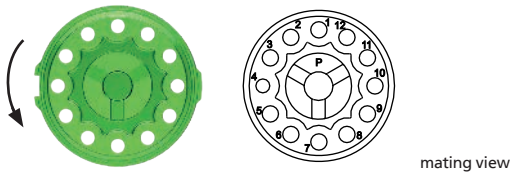

12-pin female (12 x Ø 1 mm)

Product key
 [] [] [] **0 0 2** [] [] [] [] [] [] [] [] [] [] [] [] [] []

Not part of product key. Order separately.

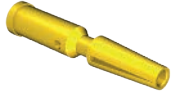

Part no. 61.232.11

Female contact Ø 1 mm
 slotted, crimping area
 0.05 - 0.75 mm²

Product key
 [] [] [] [] [] **N N 0 0** [] [] [] [] [] [] [] [] [] [] [] []

Cable Clamps



Integrated seal, anti-twist protection and coaxial screen connection

Product key	Cable damping range
[] [] [] [] [] [] [] 3 9 [] [] [] [] [] [] [] [] [] [] [] []	no hole 0.0 mm
[] [] [] [] [] [] [] 3 1 [] [] [] [] [] [] [] [] [] [] [] []	4.5 - 6.5 mm
[] [] [] [] [] [] [] 3 2 [] [] [] [] [] [] [] [] [] [] [] []	6.5 - 8.5 mm
[] [] [] [] [] [] [] 3 3 [] [] [] [] [] [] [] [] [] [] [] []	8.5 - 10.5 mm
[] [] [] [] [] [] [] 3 4 [] [] [] [] [] [] [] [] [] [] [] []	10.5 - 12.0 mm

Plug

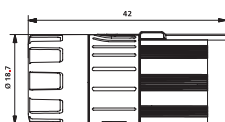

Plug

with lock fastener for automatic locking and insulation insert, 9-pin

Product key

E S T **0 5 0 0 3 0 0**
B plastic coated

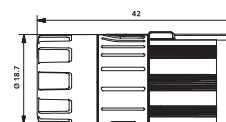

Plug

with lock fastener for automatic locking and insulation insert, 15-pin

Product key

E S T **0 0 0 3 3 0 0**
B plastic coated

Insulation Inserts and Contacts

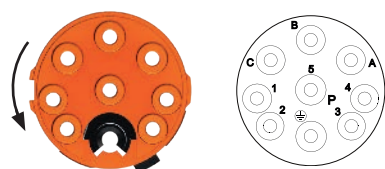

mating view

9-pin female 9 x Ø 1 mm (4 x bis 1.5 mm² (3+PE) + 5 x bis 0.75 mm²)

Product key

2 0 2

Not part of product key. Order separately.



Part no. 60.252.11

Part no. 60.251.11

Female contact Ø 1 mm

slotted, crimping area
0.05 - 0.75 mm²

slotted, crimping area
0.50 - 1.5 mm²

Product key

N N 0 0



mating view

15-pin female 15 x Ø 1 mm (12 x bis 0.75 mm² + 3 x bis 1.5 mm²)

Product key

2 0 5

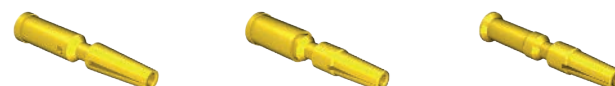

Part no. 60.252.11

Part no. 60.251.11 or

Part no. 60.265.11

slotted, crimping area
0.05 - 0.75 mm²

slotted, crimping area
0.50 - 1.5 mm²

slotted, crimping area
0.05 - 0.75 mm²

Product key

N N 0 0

Cable Clamps



Integrated seal, anti-twist protection and coaxial screen connection

Product key

3 9
3 1
3 2
3 3
3 4

Cable clamping range

no hole 0.0 mm
4.5 - 6.5 mm
6.5 - 8.5 mm
8.5 - 10.5 mm
10.5 - 12.0 mm

Plug



Plug

with coupling nut M17 x 1

Product key

A S T 200A 300

A nickel plated

Insulation Inserts and Contacts

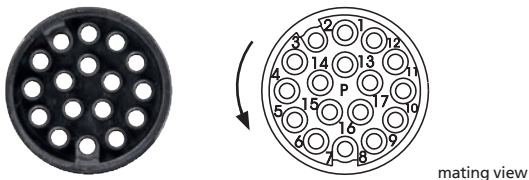

17-pin P (17 x Ø 0.6 mm)

Product key

8 7 6

Not part of product key. Order separately.



Part no. 60.205.11

Female contact Ø 0.6 mm

crimping area
0.14 – 0.5 mm²

Product key

N N 0 0

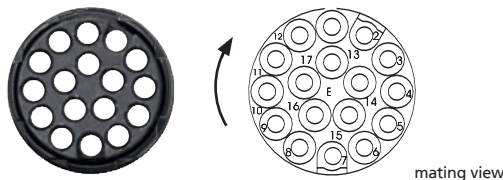

17-pin E (17 x Ø 0.6 mm)

Product key

8 7 4

Not part of product key. Order separately.



Part no. 61.178.11

Contact pin Ø 0.6 mm

crimping area
0.14 – 0.5 mm²

Product key

N N 0 0

Cable Clamps



Crown clamp

Integrated seal, anti-twist protection and coaxial screen connection

Product key

0 7	no hole	0.0 mm
8 7		3.5 - 6.0 mm
8 4		5.5 - 8.0 mm
8 5		6.0 - 9.5 mm
8 6		9.5 - 12.0 mm
8 1	1 x Ø 3.5 / 1 x Ø 7.5 mm	
8 0	2 x Ø 4.5 mm	

Cable clamping range

no hole 0.0 mm
3.5 - 6.0 mm
5.5 - 8.0 mm
6.0 - 9.5 mm
9.5 - 12.0 mm
1 x Ø 3.5 / 1 x Ø 7.5 mm
2 x Ø 4.5 mm

Additional cable clamps available on request!

Plug

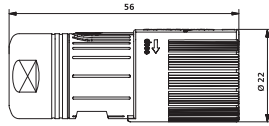

Plug

with speedtec quick-lock fastener

Product key

A S T ■ ■ ■ ■ ■ ■ ■ ■ ■ ■ 0 5 0 A ■ ■ ■ ■

A nickel plated

Insulation Inserts and Contacts

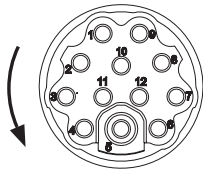

mating view

12-pin P (12 x Ø 1 mm)

Product key

■ ■ ■ ■ 0 4 6 ■ ■ ■ ■ ■ ■ ■ ■ ■ ■ ■ ■ ■ ■

Not part of product key. Order separately.



Part no. 60.001.11



Part no. 60.011.11



Part no. 60.172.11



Part no. 61.004.11



Part no. 61.083.11

Female contact Ø 1 mm

Wire spring, crimping area
0.14 - 1.0 mm²

slotted, crimping area
0.14 - 1.0 mm²

slotted, crimping area
0.03 - 0.34 mm²

Contact pin Ø 1 mm

crimping area
0.14 - 1.0 mm²

crimping area
0.03 - 0.34 mm²

Product key

■ ■ ■ ■ ■ ■ ■ ■ ■ ■ N N 0 0 ■ ■ ■ ■ ■ ■ ■ ■ ■ ■

Product key

■ ■ ■ ■ ■ ■ ■ ■ ■ ■ N N 0 0 ■ ■ ■ ■ ■ ■ ■ ■ ■ ■

Plug



Plug

with coupling nut M23 x 1

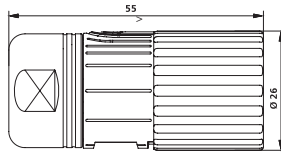

Product key

A S T 0 2 3 5 **A** nickel plated



Plug

with speedtec quick-lock fastener

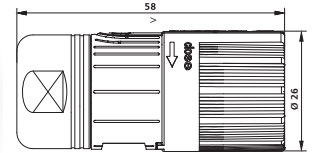

Product key

A S T 0 1 0 0 **A** nickel plated



Insulation Inserts and Contacts

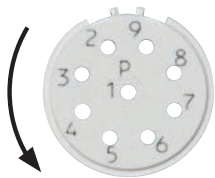

mating view

9-pin P (9 x Ø 1 mm)

uncoded

Product key

0 5 5

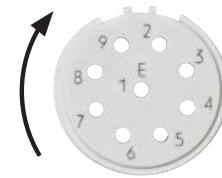

mating view

9-pin E (9 x Ø 1 mm)

uncoded

Product key

0 5 4

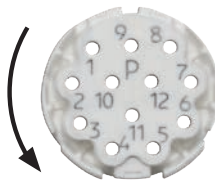

mating view

12-pin P (12 x Ø 1 mm)

uncoded

Product key

0 2 0

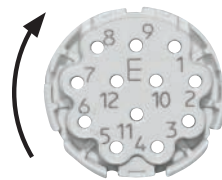

mating view

12-pin E (12 x Ø 1 mm)

uncoded

Product key

0 2 1

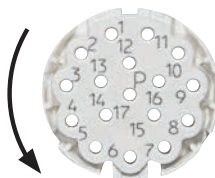

mating view

17-pin P (17 x Ø 1 mm)

uncoded

Product key

0 3 5

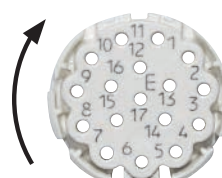

mating view

17-pin E (17 x Ø 1 mm)

uncoded

Product key

0 3 4

Not part of product key. Order separately.



Part no. 60.001.11



Part no. 60.011.11



Part no. 60.004.11



Part no. 60.013.11



Part no. 60.172.11

Female contact Ø 1 mm

wire spring, crimping area
0.14 - 1.0 mm²

slotted, crimping area
0.14 - 1.0 mm²

wire spring, solder bucket
1.5 mm²

slotted, solder bucket
1.5 mm²

slotted, crimping area
0.03 - 0.34 mm²

Product key



Product key



Not part of product key. Order separately.



Part no. 61.004.11



Part no. 61.006.11



Part no. 61.083.11

Contact pin Ø 1 mm

crimping area
0.14 - 1.0 mm²

solder bucket
1.5 mm²

crimping area
0.03 - 0.34 mm²

Product key



Insulation Inserts and Contacts

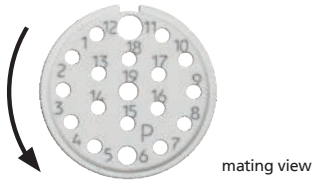

mating view

16+3-pin P (16 x Ø 1 mm + 3 x Ø 1.5 mm)

coded

Product key



Not part of product key. Order separately.



Part no. 60.001.11



Part no. 60.011.11



Part no. 60.004.11



Part no. 60.013.11



Part no. 60.172.11

Female contact Ø 1 mm

wire spring, crimping area
0.14 - 1.0 mm²

slotted, crimping area
0.14 - 1.0 mm²

wire spring, solder bucket
1.5 mm²

slotted, solder bucket
1.5 mm²

slotted, crimping area
0.03 - 0.34 mm²

Product key



Not part of product key. Order separately.



Part no. 60.070.11



Part no. 60.173.11

Female contact Ø 1.5 mm

slotted, crimping area
0.24 - 1.0 mm²

slotted, solder bucket
1.5 mm²

Product key



Not part of product key. Order separately.



Part no. 61.004.11



Part no. 61.006.11



Part no. 61.083.11



Part no. 61.072.11



Part no. 61.152.11

Contact pin Ø 1 mm

crimping area
0.14 - 1.0 mm²

solder bucket
1.5 mm²

crimping area
0.03 - 0.34 mm²

Product key



Not part of product key. Order separately.

Contact pin Ø 1.5 mm

crimping area
0.24 - 1.0 mm²

solder bucket
1.5 mm²

Product key



Not part of product key. Order separately.



Part no. 60.172.11

Part no. 60.001.11

Female contact Ø 1 mm

slotted, crimping area
0.03 - 0.34 mm²

wire spring, crimping area
0.14 - 1.0 mm²

Product key



Part no. 60.011.11

Part no. 60.216.11

slotted, crimping area
0.14 - 1.0 mm²

slotted, crimping area
0.5 - 1.5 mm²

Product key



Cable Clamps



Crown clamp

Integrated seal, anti-twist protection and coaxial screen connection



Lamella clamp

Integrated seal, anti-twist protection and coaxial screen connection

Product key



Cable clamping range

4.2 - 6.6 mm

7.5 - 12.0 mm

9.5 - 14.5 mm

Product key

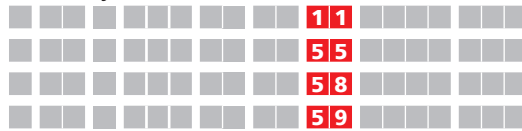

Cable clamping range

4.2 - 6.6 mm

7.5 - 12.0 mm

9.5 - 14.5 mm

14.0 - 17.0 mm

Cable clamps in the form of:

- Button seals
- Crown clamps
- Lamella clamps

Each available on request as multi-hole or no-hole clamps!

Plug

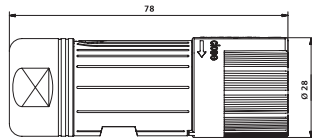

Plug

nickel plated, with speedtec quick-lock fastener

Product key

H 51 A ■ ■ ■ ■ ■ ■ ■ ■ ■ ■ **0100** ■ ■ ■ ■

Insulation Inserts and Contacts



mating view

11-pin female P Code 1 (5 x Ø 2 mm (4 + PE) + 6 x Ø 1 mm)

Product key

■ ■ ■ ■ **002** ■ ■ ■ ■ ■ ■ ■ ■ ■ ■

Not part of product key. Order separately.

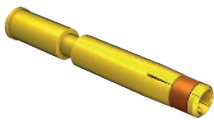

Part no. 60.270.11

Female contact Ø 2 mm

slotted, crimping area 0.35 - 2.5 mm²

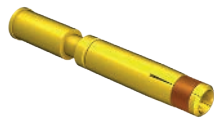

Part no. 60.272.11

slotted, crimping area 2.5 - 4.0 mm²

Product key

■ ■ ■ ■ ■ ■ ■ ■ ■ ■ **NN 00** ■ ■ ■ ■ ■ ■ ■ ■ ■ ■

Not part of product key. Order separately.

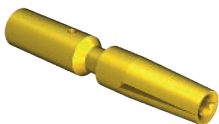

Part no. 60.279.11

Female contact Ø 1 mm

slotted, crimping area 0.14 - 1.0 mm²

Product key

■ ■ ■ ■ ■ ■ ■ ■ ■ ■ **NN 00** ■ ■ ■ ■ ■ ■ ■ ■ ■ ■



mating view

11-pin male E Code 1 (5 x Ø 2 mm (4 + PE) + 6 x Ø 1 mm)

Product key

■ ■ ■ ■ **008** ■ ■ ■ ■ ■ ■ ■ ■ ■ ■

Not part of product key. Order separately.

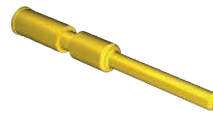

Part no. 61.242.11

Contact pin Ø 2 mm

crimping area 0.35 - 2.5 mm²

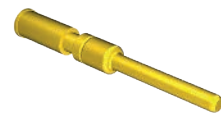

Part no. 61.243.11

crimping area 2.5 - 4.0 mm²

Product key

■ ■ ■ ■ ■ ■ ■ ■ ■ ■ **NN 00** ■ ■ ■ ■ ■ ■ ■ ■ ■ ■

Not part of product key. Order separately.

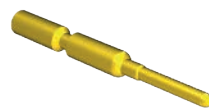

Part no. 61.253.11

Contact pin Ø 1 mm

crimping area 0.14 - 1.0 mm²

Product key

■ ■ ■ ■ ■ ■ ■ ■ ■ ■ **NN 00** ■ ■ ■ ■ ■ ■ ■ ■ ■ ■

11-pin option available:

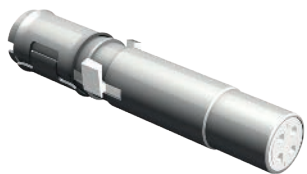

Part no. 40.A487.00

mating view

Ethernet Element Cat-5, 4-pin, Female P 4 x Ø 0.6 mm

Insulation insert 4-pin in metal screening sleeve

Product key

■ ■ ■ ■ **002 NN 00** ■ ■ ■ ■ ■ ■ ■ ■ ■ ■



Part no. 40.A486.00

mating view

Ethernet Element Cat-5, 4-pin, Stiff E 4 x Ø 0.6 mm

Insulation insert 4-pin in metal screening sleeve

Product key

■ ■ ■ ■ **008 NN 00** ■ ■ ■ ■ ■ ■ ■ ■ ■ ■

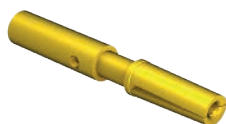

Part no. 60.278.11

Female contact Ø 0.6 mm for Ethernet Element Ø 0.6 mm

slotted, crimping area 0.03 - 0.34 mm²

Product key

■ ■



Part no. 61.252.11

Contact pin Ø 0.6 mm for Ethernet Element Ø 0.6 mm

slotted, crimping area 0.03 - 0.34 mm²

Product key

■ ■

Cable Clamps



Crown clamp

Integrated seal, anti-twist protection and coaxial screen connection



Lamella clamp

Integrated seal, anti-twist protection and coaxial screen connection

Product key

■ ■ ■ ■ ■ ■ ■ ■ ■ ■ **48** ■ ■ ■ ■ ■ ■ ■ ■ ■ ■

■ ■ ■ ■ ■ ■ ■ ■ ■ ■ **42** ■ ■ ■ ■ ■ ■ ■ ■ ■ ■

Cable clamping range

7.5 - 12.0 mm

9.5 - 14.5 mm

Product key

■ ■ ■ ■ ■ ■ ■ ■ ■ ■ **55** ■ ■ ■ ■ ■ ■ ■ ■ ■ ■

■ ■ ■ ■ ■ ■ ■ ■ ■ ■ **58** ■ ■ ■ ■ ■ ■ ■ ■ ■ ■

■ ■ ■ ■ ■ ■ ■ ■ ■ ■ **59** ■ ■ ■ ■ ■ ■ ■ ■ ■ ■

Cable clamping range

7.5 - 12.0 mm

9.5 - 14.5 mm

14.0 - 17.0 mm

Cable clamps in the form of:

- Button seals
- Crown clamps
- Lamella clamps

Each available on request as multi-hole or no-hole clamps!

Not part of product key. Order separately.



Part no. 61.004.11



Part no. 61.006.11



Part no. 61.083.11

Contact pin Ø 1 mm

crimping area
0.14 - 1.0 mm²

solder bucket
1.5 mm²

crimping area
0.03 - 0.34 mm²

Product key



Cable clamps in the form of:

- Crown clamps
- Lamella clamps

Each available on request as multi-hole or no-hole clamps!

Cable Clamps



Crown clamp

Integrated seal, anti-twist protection and coaxial screen connection

Product key

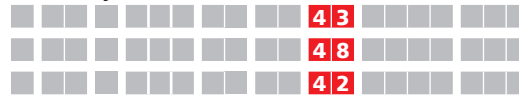

Cable clamping range

4.2 - 6.6 mm

7.5 - 12.0 mm

9.5 - 14.5 mm



Lamella clamp

Integrated seal, anti-twist protection and coaxial screen connection

Product key

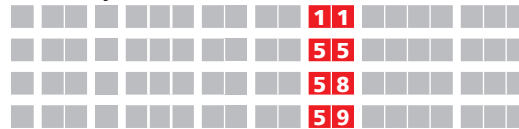

Cable clamping range

4.2 - 6.6 mm

7.5 - 12.0 mm

9.5 - 14.5 mm

14.0 - 17.0 mm

Not part of product key. Order separately.



Part no. 60.225.11

Female contact Ø 3.6 mm

slotted, crimping area
0.15 - 10 mm²



Part no. 60.227.11

slotted, crimping area
6.0 - 16.0 mm²

Product key



Not part of product key. Order separately.



Part no. 60.003.11

Female contact Ø 2 mm

wire spring, crimping area
0.35 - 2.5 mm²



Part no. 60.023.11

wire spring, crimping area
2.5 - 4.0 mm²

Product key



Not part of product key. Order separately.



Part no. 60.254.11

Female contact Ø 2 mm

tension spring, crimping area
0.35 - 2.5 mm²



Part no. 60.302.11

tension spring, crimping area
2.5 - 4.0 mm²

Product key



Cable Clamps



Crown clamp

Integrated seal, anti-twist protection and coaxial screen connection

Product key



Cable clamping range

7.0 - 9.0 mm

9.0 - 16.0 mm

16.5 - 25.5 mm

Cable clamps in the form of:

- Crown clamps
- Lamella clamps

Each available on request as multi-hole or no-hole clamps!

Plug

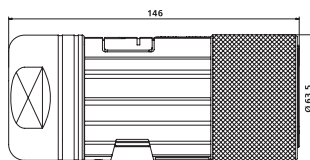

Plug

with coupling nut M58 x 2 and integrated anti-vibration o-ring

Product key

D S T 001 NN 00 74 **0001** 000

A nickel plated

Insulation Inserts and Contacts



mating view

8-pin (4 x Ø 10 mm + 4 x Ø 1.6 mm)

coded

Product key

001

Not part of product key. Order separately.



Part no. 60.101.23



Part no. 60.102.23



Part no. 60.103.23



Part no. 60.104.23



Part no. 60.105.23

Female contact Ø 10 mm

crimp connection 10 mm²

crimp connection 16 mm²

crimp connection 25 mm²

crimp connection 35 mm²

crimp connection 50 mm²

Product key

NN 00

Product key

NN 00

Not part of product key. Order separately.



Part no. 60.106.11

Female contact Ø 1.6 mm

slotted, crimping area 0.35 - 1.5 mm²

Product key

NN 00

Cable Clamps



Crown clamp

Integrated seal, anti-twist protection and coaxial screen connection

Product key



Cable clamping range

17.0 - 36.0 mm

Cable clamps in the form of:

- Crown clamps
- Lamella clamps

Each available on request as multi-hole or no-hole clamps!

locktec ... plastic-coated connectors



locktec – plastic coated!

- Bend protection
- IP 66/67 protection
- Robust metal housing
- EMC-screening
- speedtec or screw fastener
- Individual labelling and colour
- Standard and special cables in different lengths
- UL 94/V0 certified plastics
- All standard pin layouts
- Individual cable lengths

Crimping Tools



Part no. C0.101.00

Crimp Tool, small

For Ø 1 mm contacts, max. wire gauge 1.5 mm², includes positioner. Complete with positioning insert.



Part no. C0.231.00

Crimp Tool, small

For Ø 0.6 mm contacts, max. wire gauge 1.0 mm², includes positioner. Complete with positioning insert.



Part no. C0.201.00

Crimp Tool, mid-size

For Ø 1 mm and Ø 2 mm contacts, max. wire gauge 4 mm², includes positioner.



Part no. C0.008.00

Crimp Tool, large

For Ø 3.6 mm contacts, max. wire gauge 16 mm², includes positioner.

Series	615	915	617	917	623	923	627	932	940	958	723
--------	-----	-----	-----	-----	-----	-----	-----	-----	-----	-----	-----

Crimp Tool, small		615	915	617	917	623	923	627	932	940	958	723
C0.101.00	with Positioning Insert	■	■	■		■	■	■	■			

Crimp Tool, small		615	915	617	917	623	923	627	932	940	958	723
C0.231.00	with Positioning Insert			■								

Crimp Tool, mid-size		615	915	617	917	623	923	627	932	940	958	723
C0.201.00		■	■		■	■	■	■	■	■	■	■
	Positioning Insert											
	C0.258.00	■	■									
	C0.003.00	■	■		■	■	■	■	■			
	C0.121.00				■							
	C0.229.00				■							
	C0.048.00					■						
	C0.012.00					■						
	C0.004.00						■		■	■		
	C0.252.00						■					
	C0.009.00						■			■		
	C0.124.00								■			
	C0.094.00										■	
	C0.093.00										■	
	C0.092.00										■	
	C0.138.00											■

Crimp Tool, large		615	915	617	917	623	923	627	932	940	958	723
C0.008.00					■						■	
	Positioning Insert											
	C0.249.00				■							
	C0.010.00									■		
	C0.247.00									■		

Akku Crimp Tool		615	915	617	917	623	923	627	932	940	958	723
C0.207.00												■
	Crimping Insert											
	C0.211.00											■
	C0.210.00											■
	C0.209.00											■
	C0.208.00											■



Part no. C0.207.00

Rechargeable Battery - Crimp Tool B132

For Ø 10.0 mm contacts, max. wire gauge 50 mm².

Crimping Tools

Positioning Insert for C0.201.00 for Ø 1.0 mm Contacts

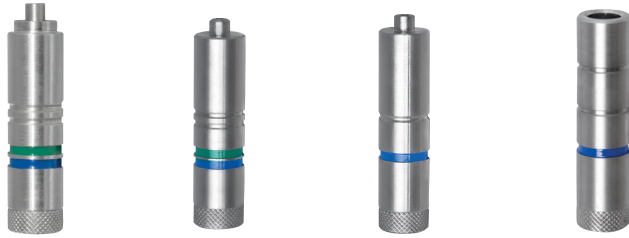

Part no. C0.258.00 Part no. C0.003.00 Part no. C0.121.00 Part no. C0.252.00

for Ø 1.5 mm Contacts

for Ø 1.6 mm Contacts



Part no. C0.229.00 Part no. C0.048.00 Part no. C0.094.00 Part no. C0.093.00 Part no. C0.092.00

for Ø 2 mm Contacts



Part no. C0.012.00 Part no. C0.004.00 Part no. C0.009.00 Part no. C0.138.00

for Ø 2.5 mm Contacts

Positioning Insert for C0.008.00 for Ø 3.6 mm Contacts



Part no. C0.124.00 Part no. C0.249.00 Part no. C0.247.00 Part no. C0.247.00

Crimping Inserts for C0.207.00



Part no. C0.211.00 Part no. C0.210.00 Part no. C0.209.00 Part no. C0.208.00

crimping area
10.0 mm² / 16.0 mm²

crimping area
25.0 mm²

crimping area
35.0 mm²

crimping area
50.0 mm²

Pliers	Positioning Inserts	Sockets	Pins
C0.101.00	with Positioning Insert	60.001.11	61.004.11
		60.011.11	61.083.11
		60.159.11	61.141.11
		60.172.11	
C0.231.00	with Positioning Insert	60.205.11	61.178.11
C0.201.00	C0.258.00	60.251.11	61.231.11
		60.252.11	61.232.11
		60.265.11	61.239.11
	C0.003.00	60.001.11	61.004.11
		60.011.11	61.009.11
			61.054.11
	C0.121.00	60.159.11	61.141.11
	C0.229.00	60.197.11	61.167.11
	C0.048.00	60.070.11	61.072.11
	C0.012.00	60.012.11	61.008.11
	C0.004.00	60.003.11	61.010.11
		60.023.11	61.021.11
		60.254.11	61.022.11
		60.302.11	61.023.11
			61.055.11
			61.193.11
			61.194.11
			61.216.11
	C0.252.00	60.216.11	61.189.11
	C0.009.00	60.012.11	61.020.11
		61.098.11	61.021.11
		61.107.11	61.027.11
		61.108.11	61.197.11
		61.109.11	61.198.11
			61.204.11
			61.205.11
	C0.124.00	60.204.11	61.176.11
	C0.094.00		61.142.11
	C0.093.00		61.117.11
	C0.092.00	60.106.11	
	C0.138.00	60.272.11	61.243.11
C0.008.00	C0.249.00	60.240.11	61.220.11
		60.232.11	61.215.11
	C0.010.00	60.225.11	61.039.11
		60.227.11	61.040.11
			61.073.11
			61.074.11
	C0.247.00	61.195.11	61.202.11
		61.196.11	61.203.11

Pliers	Crimping Inserts	Sockets	Pins
C0.207.00	C0.211.00	60.101.23	61.112.23
		60.102.23	61.113.23
	C0.210.00	60.103.23	61.114.23
	C0.209.00	60.104.23	61.115.23
	C0.208.00	60.105.23	61.116.23

- kink protection
 - metal flange
 - caps
 - assembly tools
 - pick and place
- and other accessories
available on request!

The enhanced TOPSERV® family – new and improved!

What is new?

- **TOPSERV® 109 SINGLE:** screened, halogen-free, highly flexible single core; suitable for use in drag chains
- **TOPSERV® HYBRID PUR:** highly flexible servo cable; suitable for use in drag chains with an additional screened signal pair for transmission of feedback signals where single-cable solutions are required
- **TOPSERV® HYBRID PVC:** cost-effective alternative to TOPSERV® HYBRID PUR where flexibility and limited use in drag chains is required

What has been improved?

We have optimised our family of servo cables for use in drag chains in terms of both their design and performance:

- Optimised **overall diameter**
- **Low capacitance** (for cables used in fixed installations up to 6 mm²)
- Compatible with **all drive manufacturers**, uniform core marking
- **Harmonised drag chain suitability**

		Single core	4 cores (3+g/y) without additional signal pair	4 cores (3+g/y) + 1 additional signal pair	4 cores (3+g/y) + 2 additional signal pairs
HIGHLY FLEXIBLE e.g, for use in drag chains	without UL / CSA			TOPSERV® 110 according to Siemens standard 6FX2008	TOPSERV® 120
	UL / CSA	TOPSERV® 109 Single screened single core for screw drives	TOPSERV® 109 according to Siemens standard 6FX8008Plus	TOPSERV® 113 according to Siemens standard 6FX8008Plus, Lenze standard etc.	TOPSERV® 121 according to Bosch Rexroth standard
					TOPSERV® Hybrid PUR (for motors with single-cable solution)
FLEXIBLE limited use in drag chains	UL / CSA		TOPSERV® 108 according to Siemens standard 6FX5008	TOPSERV® 112 according to Siemens standard 6FX5008, Lenze standard	TOPSERV® 119 similar to Bosch Rexroth standard
					TOPSERV® Hybrid PVC (for motors with single-cable solution)

Siemens 6FX5008..., Siemens 6FX8008Plus... are registered trademarks of SIEMENS AG and are to be used only for purposes of comparison. INDRAMAT INK... are registered trademarks of BOSCH REXROTH AG and are to be used only for purposes of comparison. LENZE ... are registered trademarks of LENZE AG and are to be used only for purposes of comparison.

The Sensational Quick-Lock Fastener
The robust and vibration-proof locking mechanism provides added safety when using M17, M23 and M40 connectors.

EMV/EMC

IP 66/67

-20G-
VIBRATION-RESISTANT



SPEEDTEC® ... the sensational quick-lock fastener

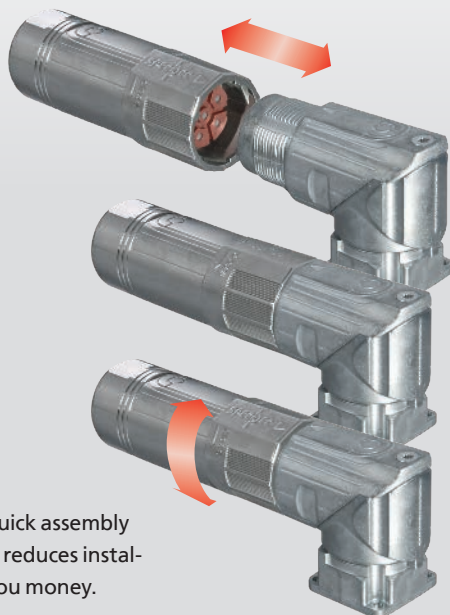

**Slide on ...
Turn ... Locked.**

Secure, stable and quick assembly with minimal twist – reduces installation time to save you money.



**Fast ... Safe ...
Compatible.**

speedtec receptacles are compatible with speedtec plugs as well as standard coupling nut connectors.

По вопросам продаж и поддержки обращайтесь:

Алматы (7273)495-231	Казань (843)206-01-48	Новокузнецк (3843)20-46-81	Смоленск (4812)29-41-54
Архангельск (8182)63-90-72	Калининград (4012)72-03-81	Новосибирск (383)227-86-73	Сочи (862)225-72-31
Астрахань (8512)99-46-04	Калуга (4842)92-23-67	Омск (3812)21-46-40	Ставрополь (8652)20-65-13
Барнаул (3852)73-04-60	Кемерово (3842)65-04-62	Орел (4862)44-53-42	Сургут (3462)77-98-35
Белгород (4722)40-23-64	Киров (8332)68-02-04	Оренбург (3532)37-68-04	Тверь (4822)63-31-35
Брянск (4832)59-03-52	Краснодар (861)203-40-90	Пенза (8412)22-31-16	Томск (3822)98-41-53
Владивосток (423)249-28-31	Красноярск (391)204-63-61	Пермь (342)205-81-47	Тула (4872)74-02-29
Волгоград (844)278-03-48	Курск (4712)77-13-04	Ростов-на-Дону (863)308-18-15	Тюмень (3452)66-21-18
Вологда (8172)26-41-59	Липецк (4742)52-20-81	Рязань (4912)46-61-64	Ульяновск (8422)24-23-59
Воронеж (473)204-51-73	Магнитогорск (3519)55-03-13	Самара (846)206-03-16	Уфа (347)229-48-12
Екатеринбург (343)384-55-89	Москва (495)268-04-70	Санкт-Петербург (812)309-46-40	Хабаровск (4212)92-98-04
Иваново (4932)77-34-06	Мурманск (8152)59-64-93	Саратов (845)249-38-78	Челябинск (351)202-03-61
Ижевск (3412)26-03-58	Набережные Челны (8552)20-53-41	Севастополь (8692)22-31-93	Череповец (8202)49-02-64
Иркутск (395)279-98-46	Нижний Новгород (831)429-08-12	Симферополь (3652)67-13-56	Ярославль (4852)69-52-93
Россия (495)268-04-70	Киргизия (996)312-96-26-47	Казахстан (7172)727-132	