

# ( )

## Технические характеристики

### По вопросам продаж и поддержки обращайтесь:

Алматы (7273)495-231	Казань (843)206-01-48	Новокузнецк (3843)20-46-81	Смоленск (4812)29-41-54
Архангельск (8182)63-90-72	Калининград (4012)72-03-81	Новосибирск (383)227-86-73	Сочи (862)225-72-31
Астрахань (8512)99-46-04	Калуга (4842)92-23-67	Омск (3812)21-46-40	Ставрополь (8652)20-65-13
Барнаул (3852)73-04-60	Кемерово (3842)65-04-62	Орел (4862)44-53-42	Сургут (3462)77-98-35
Белгород (4722)40-23-64	Киров (8332)68-02-04	Оренбург (3532)37-68-04	Тверь (4822)63-31-35
Брянск (4832)59-03-52	Краснодар (861)203-40-90	Пенза (8412)22-31-16	Томск (3822)98-41-53
Владивосток (423)249-28-31	Красноярск (391)204-63-61	Пермь (342)205-81-47	Тула (4872)74-02-29
Волгоград (844)278-03-48	Курск (4712)77-13-04	Ростов-на-Дону (863)308-18-15	Тюмень (3452)66-21-18
Вологда (8172)26-41-59	Липецк (4742)52-20-81	Рязань (4912)46-61-64	Ульяновск (8422)24-23-59
Воронеж (473)204-51-73	Магнитогорск (3519)55-03-13	Самара (846)206-03-16	Уфа (347)229-48-12
Екатеринбург (343)384-55-89	Москва (495)268-04-70	Санкт-Петербург (812)309-46-40	Хабаровск (4212)92-98-04
Иваново (4932)77-34-06	Мурманск (8152)59-64-93	Саратов (845)249-38-78	Челябинск (351)202-03-61
Ижевск (3412)26-03-58	Набережные Челны (8552)20-53-41	Севастополь (8692)22-31-93	Череповец (8202)49-02-64
Иркутск (395)279-98-46	Нижний Новгород (831)429-08-12	Симферополь (3652)67-13-56	Ярославль (4852)69-52-93
Россия (495)268-04-70	Киргизия (996)312-96-26-47	Казахстан (7172)727-132	

# Cable conduit and Cable grips

## Cable conduit with inner striations

Suitable for plowing-in, laying in trenches, for blowing-in and pulling-in fiber optic cable, outside diameter 32 to 50 mm.



## Cable installation grips with side loop

### Properties:

- with thimble and press clamp
- self-tightening under tension load
- back-woven



### Material:

galvanized stranded wire

### Application

Employed as a cable installation grip. For anti-slip installation of vertically attached cables.

### Cable installation grips with side loop, laterally displaced, open

Part no.	Min. interior diameter mm	Max. interior diameter mm	Length mm	Loadability in kN	Weight kg
905909	8	10	500	2,2	0,07
905601	10	15	500	3,4	0,08
905602	15	20	500	4,3	0,14
905603	20	25	500	6,8	0,16
905604	25	30	500	8,1	0,18
905597	30	40	500	11,7	0,4
905605	40	50	800	16,0	0,45
905606	50	60	800	16,0	0,6
905607	60	70	800	21,0	0,7
905918	70	90	800	21,0	0,9
905919	90	110	800	26,7	1,2

Dimensions and specifications may be changed without prior notice. Prices on request.

## Cable grips with thimble and press clamp

### Properties:

- with thimble and press clamp
- self-tightening under tension load
- back-woven



### Material:

galvanized stranded wire

### Application

This cable grip is used wherever cables with high tensile forces are routed.

### Cable grips with thimble and press clamp, closed

Part no.	Min. interior diameter mm	Max. interior diameter mm	Length mm	Loadability in kN	Weight kg
905891	6	10	600	2,2	0,07
905892	10	15	600	3,4	0,08
905893	15	20	600	6,8	0,14
905375	20	25	600	6,8	0,15
905371	25	30	1000	8,1	0,18
905376	30	40	1250	11,7	0,4
905894	40	50	1250	16,0	0,45
905163	50	60	1500	16,0	0,6
905895	60	70	1500	21,3	0,7
905896	70	90	1500	27,9	0,9
905897	90	110	1500	34,9	1,5

Dimensions and specifications may be changed without prior notice. Prices on request.

# Cable gland – HELUTOP®

## HELUTOP® HT

The plastic cable gland with vibration protection.

### Properties:

- Optimum strain relief through clamping plates
- Easy to assemble
- Large clamping areas



### Technical Data:

Protection classification: IP 68 - 5 bar / IP69 K  
Temperature range: -30°C up to +80°C  
Testing standard: EN50262

### Material:

• Halogen-free  
• Silicone-free  
• Cadmium-free  
Shell: polyamide PA 6  
Moulded seal: Neoprene

## HELUTOP® HT-MS

The cable gland made of nickel-plated brass.

### Properties:

- Optimum strain relief through clamping plates
- Easy to assemble
- Large clamping areas



### Technical Data:

Protection classification: IP 68 - 5 bar / IP69 K  
Temperature range: -40°C up to +100°C  
Testing standard: EN50262

### Material:

Shell: brass, nickel-plated  
Terminal insert: polyamide PA 6  
Moulded seal: Neoprene  
O-ring: Buna-N

## HELUTOP® MS-EP4

The new generation of EMC and earth glands with integrated contact system for reliable, quick assembly and contacting.

### Properties:

- Optimum strain relief by means of clamping plates
- Large clamping areas
- Simple installation with open contact springs and rotating spring ring
- Reliable contact with high-quality copper-beryllium springs
- Highly vibration-resistant due to short distance from clamping to contact range
- Reliable EMC screening even in rugged applications



### Technical Data:

Protection classification: IP68 – 5bar / IP69 K  
Temperature range: -40°C bis +100°C  
Testing standard: EN 50262

### Material:

Shell: brass, nickel-plated  
Contact spring: Copper-beryllium  
Terminal insert: polyamide PA 6  
Gasket: Neoprene  
O-ring: NBR

## HELUTOP® HT-E

The stainless steel cable gland for use in high-stress applications.

### Properties:

- Optimum strain relief through clamping plates
- Highly corrosion-resistant
- Highly durable
- Easy to assemble
- Large clamping areas



### Technical Data:

Protection classification: IP 68 - 5 bar / IP69 K  
Temperature range: -40°C up to +100°C  
Testing standard: EN50262

### Material:

stainless steel 1.4305  
Terminal insert: polyamide PA 6  
Moulded seal: Neoprene  
O-ring: Buna-N

# HELU-S-PK-CU-DIN Tubular compression cable lugs - straight



## Tubular compression lug HELU-S-PK-CU-DIN

Uninsulated tubular compression lugs in eye type design for conductor arrangement RM, to DIN 46235.

### Material

Socket: Copper according to DIN EN 13600  
Surface: tin plated or optionally uncoated

### Note

Code type indicates the required hexagonal clamping insert.  
Compression instruction and instruction for assembly see chapter "Technical information".

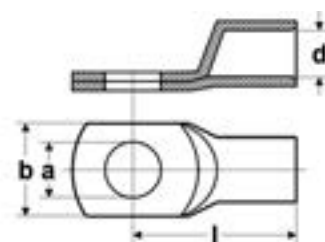

### Diameter

- a Diameter of the boring
- d Inner diameter of the cable insertion
- b Flange width
- l Length till middle of the boring

### eye type

Part no.	Type	Cross-section mm <sup>2</sup>	a mm	d mm	b mm	l mm	Code type	Weight kg / 1000 items	Unit
907677	HELU-S-PK-CU-DIN 6-5	6,0	5,3	3,7	8,5	24,0	5	3,1	100
907678	HELU-S-PK-CU-DIN 6-6	6,0	6,4	3,7	3,7	24,0	5	3,4	100
907680	HELU-S-PK-CU-DIN 10-5	10,0	5,3	4,4	10,0	27,0	6	3,5	100
907681	HELU-S-PK-CU-DIN 10-6	10,0	6,4	4,4	10,0	27,0	6	3,7	100
907685	HELU-S-PK-CU-DIN 16-6	16,0	6,4	5,5	13,0	36,0	8	12,7	100
907686	HELU-S-PK-CU-DIN 16-8	16,0	8,4	5,5	13,0	37,0	8	13,0	100
907687	HELU-S-PK-CU-DIN 16-10	16,0	10,5	5,5	16,5	38,0	8	13,2	100
907689	HELU-S-PK-CU-DIN 25-6	25,0	6,4	7,0	14,0	39,0	10	16,2	100
907690	HELU-S-PK-CU-DIN 25-8	25,0	8,4	7,0	17,0	39,0	10	17,3	100
907691	HELU-S-PK-CU-DIN 25-10	25,0	10,5	7,0	17,0	40,5	10	17,7	100
907692	HELU-S-PK-CU-DIN 25-12	25,0	13,0	7,0	18,0	40,5	10	17,2	100
907695	HELU-S-PK-CU-DIN 35-8	35,0	8,4	8,2	18,0	42,0	12	31,9	100
907696	HELU-S-PK-CU-DIN 35-10	35,0	10,5	8,2	20,0	42,5	12	31,7	100
907697	HELU-S-PK-CU-DIN 35-12	35,0	13,0	8,2	21,0	44,0	12	31,1	100
907701	HELU-S-PK-CU-DIN 50-8	50,0	8,4	9,8	20,0	52,0	14	50,0	100
907702	HELU-S-PK-CU-DIN 50-10	50,0	10,5	9,8	22,0	52,0	14	49,4	100
907703	HELU-S-PK-CU-DIN 50-12	50,0	13,0	9,8	23,0	52,0	14	49,1	100
907705	HELU-S-PK-CU-DIN 50-16	50,0	17,0	9,8	28,0	55,5	14	50,4	100
907707	HELU-S-PK-CU-DIN 70-8	70,0	8,4	11,3	24,0	56,0	16	65,4	50
907708	HELU-S-PK-CU-DIN 70-10	70,0	10,5	11,3	24,0	56,0	16	65,4	50
907709	HELU-S-PK-CU-DIN 70-12	70,0	13,0	11,3	24,0	56,5	16	65,7	50
907711	HELU-S-PK-CU-DIN 70-16	70,0	17,0	11,3	29,0	57,0	16	69,2	50
906524	HELU-S-PK-CU-DIN 95-10	95,0	10,5	13,5	28,0	65,5	18	95,5	50
906525	HELU-S-PK-CU-DIN 95-12	95,0	13,0	13,5	28,0	65,5	18	94,5	50
907715	HELU-S-PK-CU-DIN 95-16	95,0	17,0	13,5	30,0	65,5	18	94,4	50
907716	HELU-S-PK-CU-DIN 95-20	95,0	21,0	13,5	33,0	71,0	18	98,6	50
906526	HELU-S-PK-CU-DIN 120-10	120,0	10,5	15,5	31,0	70,0	20	114,0	50
906527	HELU-S-PK-CU-DIN 120-12	120,0	13,0	15,5	31,0	70,5	20	114,3	50
907719	HELU-S-PK-CU-DIN 120-16	120,0	17,0	15,5	31,5	70,0	20	113,6	50
907720	HELU-S-PK-CU-DIN 120-20	120,0	21,0	15,5	36,0	72,0	20	115,1	50
907722	HELU-S-PK-CU-DIN 150-10	150,0	10,5	17,0	34,0	79,0	22	164,6	25
906528	HELU-S-PK-CU-DIN 150-12	150,0	13,0	17,0	34,0	78,5	22	165,3	25
906529	HELU-S-PK-CU-DIN 150-16	150,0	17,0	17,0	34,0	78,0	22	163,5	25
907724	HELU-S-PK-CU-DIN 150-20	150,0	21,0	17,0	38,0	78,0	22	163,4	25
907726	HELU-S-PK-CU-DIN 185-10	185,0	10,5	19,0	37,0	83,0	25	185,0	25
906530	HELU-S-PK-CU-DIN 185-12	185,0	13,0	19,0	37,0	82,5	25	189,5	25
906531	HELU-S-PK-CU-DIN 185-16	185,0	17,0	19,0	37,0	82,0	25	194,1	25

Continuation ▶

# HELU-S-PK-CU-DIN Tubular compression cable lugs - straight

## eye type

Part no.	Type	Cross-section mm <sup>2</sup>	a mm	d mm	b mm	l mm	Code type	Weight kg / 1000 items	Unit	
907728	HELU-S-PK-CU-DIN 185-20	185,0	21,0	19,0	40,0	83,0	25	190,1	25	-
906532	HELU-S-PK-CU-DIN 240-12	240,0	13,0	21,5	42,5	92,0	28	266,5	20	-
906533	HELU-S-PK-CU-DIN 240-16	240,0	17,0	21,5	42,5	92,0	28	274,5	20	-
907731	HELU-S-PK-CU-DIN 240-20	240,0	21,0	21,5	45,0	92,0	28	276,7	20	-
906534	HELU-S-PK-CU-DIN 300-16	300,0	17,0	24,5	48,5	100,0	32	341,6	10	-
906535	HELU-S-PK-CU-DIN 300-20	300,0	21,0	24,5	48,5	100,0	32	344,6	10	-
906536	HELU-S-PK-CU-DIN 400-16	400,0	17,0	27,5	55,0	117,0	38	717,5	5	-
906537	HELU-S-PK-CU-DIN 400-20	400,0	21,0	27,5	55,0	117,0	38	706,4	5	-
906538	HELU-S-PK-CU-DIN 500-20	500,0	21,0	31,0	60,0	130,0	42	876,6	5	-
907744	HELU-S-PK-CU-DIN 625-20	625,0	21,0	34,5	63,0	135,0	44	820,5	5	-
907747	HELU-S-PK-CU-DIN 800-20	800,0	21,0	40,0	75,0	165,0	100	1455,5	2	-
907749	HELU-S-PK-CU-DIN 1000-20	1000,0	21,0	44,0	83,0	167,0	58	1890,0	2	-

Dimensions and specifications may be changed without prior notice.

# HELU-S-RK-CU Copper tubular cable lug - straight

uninsulated



## Tubular cable lug

### HELU-S-RK-CU

Uninsulated, straight tubular cable lugs in eye type design.

## Material

Socket: Copper according to DIN EN 13600  
Surface: tin plated

## Note

Also available in angulated version (45° and 90°).  
Compression instruction and instruction for assembly see chapter "Technical information".

## Technical data

Temperature range: up to +120°C

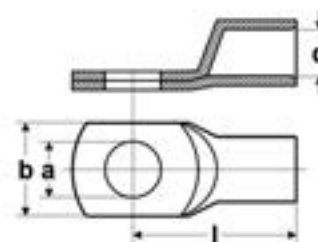

## Abmessungen

- a Diameter of the boring
- d Inner diameter of the cable insertion
- b Flange width
- l Length till middle of the boring

## eye type

Part no.	Type	Cross-section mm <sup>2</sup>	a mm	d mm	b mm	l mm	Code type	Weight kg / 1000 items	Unit	
907303	HELU-S-RK-CU 0,75-3	0,75	3,2	1,4	6,5	12,5	-	0,7	100	-
907304	HELU-S-RK-CU 0,75-4	0,75	4,3	1,4	8,5	14,0	-	0,8	100	-
907305	HELU-S-RK-CU 0,75-5	0,75	5,3	1,4	10,0	15,0	-	1,0	100	-
907306	HELU-S-RK-CU 1,5-3	1,5	3,2	1,9	6,5	14,0	-	1,2	100	-
907307	HELU-S-RK-CU 1,5-4	1,5	4,3	1,9	8,5	15,0	-	1,4	100	-
907308	HELU-S-RK-CU 1,5-5	1,5	5,3	1,9	10,0	16,0	-	1,5	100	-
907309	HELU-S-RK-CU 1,5-6	1,5	6,4	1,9	11,0	18,0	-	1,7	100	-
907310	HELU-S-RK-CU 2,5-4	2,5	4,3	2,4	8,5	15,0	-	1,6	100	-
907311	HELU-S-RK-CU 2,5-5	2,5	5,3	2,4	10,0	16,0	-	1,8	100	-
907312	HELU-S-RK-CU 2,5-6	2,5	6,4	2,4	11,0	18,0	-	1,9	100	-
907313	HELU-S-RK-CU 2,5-8	2,5	8,4	2,4	13,0	20,0	-	2,2	100	-
907314	HELU-S-RK-CU 4-4	4,0	4,3	3,0	8,5	17,0	-	2,2	100	-
907315	HELU-S-RK-CU 4-5	4,0	5,3	3,0	10,0	18,0	-	2,4	100	-
907316	HELU-S-RK-CU 4-6	4,0	6,3	3,0	11,0	20,0	-	2,6	100	-
907317	HELU-S-RK-CU 4-8	4,0	8,4	3,0	14,0	22,0	-	3,0	100	-

Dimensions and specifications may be changed without prior notice.

# HELU-S-RK-CU-UL Tubular cable lug - straight



uninsulated



## Tubular cable lug HELU-S-RK-CU-UL

Uninsulated, straight tubular cable lugs in eye type design.

## Material

Socket: Copper according to DIN EN 13600  
Surface: tin plated

## Technical data

Temperature range: up to +120°C

## Note

Also available in angulated version (45° and 90°).

Compression instruction and instruction for assembly see chapter "Technical information".

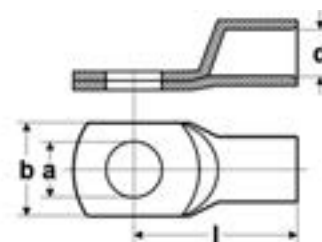

## Abmessungen

- a Diameter of the boring
- d Inner diameter of the cable insertion
- b Flange width
- l Length till middle of the boring

## eye type

Part no.	Type	Cross-section mm <sup>2</sup>	a mm	d mm	b mm	l mm	Code type	Weight kg / 1000 items	Unit
907318	HELU-S-RK-CU-UL 6-4	6,0	4,3	3,5	10,0	19,0	-	4,6	100
907319	HELU-S-RK-CU-UL 6-5	6,0	5,3	3,5	10,0	20,0	-	4,7	100
907320	HELU-S-RK-CU-UL 6-6	6,0	6,4	3,5	11,0	21,5	-	5,4	100
907321	HELU-S-RK-CU-UL 6-8	6,0	8,4	3,5	15,0	24,0	-	5,9	100
907322	HELU-S-RK-CU-UL 6-10	6,0	10,5	3,5	18,0	26,0	-	6,4	100
907323	HELU-S-RK-CU-UL 6-12	6,0	13,0	3,5	19,0	27,5	-	6,4	100
907324	HELU-S-RK-CU-UL 10-4	10,0	4,3	4,5	12,0	20,0	-	4,3	100
907325	HELU-S-RK-CU-UL 10-5	10,0	5,3	4,5	12,0	21,0	-	4,8	100
907326	HELU-S-RK-CU-UL 10-6	10,0	6,4	4,5	12,0	22,5	-	5,1	100
907327	HELU-S-RK-CU-UL 10-8	10,0	8,4	4,5	15,0	25,0	-	5,8	100
907328	HELU-S-RK-CU-UL 10-10	10,0	10,5	4,4	18,0	27,0	-	6,3	100
907329	HELU-S-RK-CU-UL 10-12	10,0	13,0	4,5	20,0	28,5	-	6,3	100
907330	HELU-S-RK-CU-UL 16-4	16,0	4,3	5,5	12,0	24,0	-	8,2	100
907331	HELU-S-RK-CU-UL 16-5	16,0	5,3	5,5	12,0	25,0	-	8,9	100
907332	HELU-S-RK-CU-UL 16-6	16,0	6,4	5,5	12,0	26,5	-	9,6	100
907333	HELU-S-RK-CU-UL 16-8	16,0	8,4	5,5	15,0	29,0	-	10,3	100
907334	HELU-S-RK-CU-UL 16-10	16,0	10,5	5,5	18,0	31,0	-	11,0	100
907335	HELU-S-RK-CU-UL 16-12	16,0	13,0	5,5	19,0	32,0	-	10,8	100
907336	HELU-S-RK-CU-UL 25-5	25,0	5,3	7,0	15,0	33,5	-	13,5	100
907337	HELU-S-RK-CU-UL 25-6	25,0	6,4	7,0	15,0	31,5	-	13,1	100
907338	HELU-S-RK-CU-UL 25-8	25,0	8,4	7,0	16,0	33,0	-	12,9	100
907339	HELU-S-RK-CU-UL 25-10	25,0	10,5	7,0	18,0	34,5	-	14,6	100
907340	HELU-S-RK-CU-UL 25-12	25,0	13,0	7,0	20,0	36,0	-	15,5	100
907341	HELU-S-RK-CU-UL 25-14	25,0	15,0	7,0	22,0	39,0	-	16,6	100
907342	HELU-S-RK-CU-UL 25-16	25,0	17,0	7,0	24,0	42,0	-	17,3	100
907343	HELU-S-RK-CU-UL 35-6	35,0	6,4	8,5	17,0	33,0	-	20,7	100
907344	HELU-S-RK-CU-UL 35-8	35,0	8,4	8,5	17,0	34,0	-	21,8	100
907345	HELU-S-RK-CU-UL 35-10	35,0	10,5	8,5	20,0	36,5	-	21,9	100
907346	HELU-S-RK-CU-UL 35-12	35,0	13,0	8,5	22,0	37,5	-	23,3	100
907347	HELU-S-RK-CU-UL 35-14	35,0	15,0	8,5	23,0	40,0	-	24,4	100

Continuation ▶

# HELU-S-RK-CU-UL Tubular cable lug - straight



uninsulated

eye type

Part no.	Type	Cross-section mm <sup>2</sup>	a mm	d mm	b mm	l mm	Code type	Weight kg / 1000 items	Unit	
907348	HELU-S-RK-CU-UL 35-16	35,0	17,0	8,5	28,0	44,0	-	26,0	100	-
907349	HELU-S-RK-CU-UL 50-6	50,0	6,4	10,0	20,0	37,0	-	30,1	100	-
907350	HELU-S-RK-CU-UL 50-8	50,0	8,4	10,0	20,0	39,0	-	30,4	100	-
907351	HELU-S-RK-CU-UL 50-10	50,0	10,5	10,0	20,0	40,5	-	31,3	100	-
907352	HELU-S-RK-CU-UL 50-12	50,0	13,0	10,0	23,0	42,0	-	31,3	100	-
907353	HELU-S-RK-CU-UL 50-14	50,0	15,0	10,0	23,0	44,0	-	35,1	100	-
907354	HELU-S-RK-CU-UL 50-16	50,0	17,0	10,0	27,0	46,0	-	35,5	100	-
907355	HELU-S-RK-CU-UL 50-20	50,0	21,0	10,0	30,5	52,5	-	38,9	100	-
907356	HELU-S-RK-CU-UL 70-6	70,0	6,4	12,0	24,0	40,5	-	41,1	25	-
907357	HELU-S-RK-CU-UL 70-8	70,0	8,4	12,0	24,0	42,5	-	44,6	25	-
907358	HELU-S-RK-CU-UL 70-10	70,0	10,5	12,0	24,0	43,5	-	46,4	25	-
907359	HELU-S-RK-CU-UL 70-12	70,0	13,0	12,0	24,0	45,0	-	47,3	25	-
907360	HELU-S-RK-CU-UL 70-14	70,0	15,0	12,0	25,0	46,0	-	49,1	25	-
907361	HELU-S-RK-CU-UL 70-16	70,0	17,0	12,0	28,0	48,5	-	49,6	25	-
907362	HELU-S-RK-CU-UL 70-20	70,0	21,0	12,0	29,0	52,0	-	52,9	25	-
907363	HELU-S-RK-CU-UL 95-6	95,0	6,4	13,5	26,0	43,0	-	49,5	25	-
907364	HELU-S-RK-CU-UL 95-8	95,0	8,4	13,5	26,0	46,0	-	53,6	25	-
907365	HELU-S-RK-CU-UL 95-10	95,0	10,5	13,5	26,0	47,0	-	55,1	25	-
907366	HELU-S-RK-CU-UL 95-12	95,0	13,0	13,5	26,0	48,0	-	55,1	25	-
907367	HELU-S-RK-CU-UL 95-14	95,0	15,0	13,5	26,0	51,5	-	58,9	25	-
907368	HELU-S-RK-CU-UL 95-16	95,0	17,0	13,5	28,0	51,0	-	58,5	25	-
907369	HELU-S-RK-CU-UL 95-20	95,0	21,0	13,5	30,0	55,0	-	61,3	25	-
907370	HELU-S-RK-CU-UL 120-8	120,0	8,4	15,0	29,0	49,5	-	68,8	25	-
907371	HELU-S-RK-CU-UL 120-10	120,0	10,5	15,0	29,0	52,0	-	79,9	25	-
907372	HELU-S-RK-CU-UL 120-12	120,0	13,0	15,0	29,0	51,5	-	78,4	25	-
907373	HELU-S-RK-CU-UL 120-14	120,0	15,0	15,0	30,0	53,0	-	78,6	25	-
907374	HELU-S-RK-CU-UL 120-16	120,0	17,0	15,0	30,0	55,0	-	80,7	25	-
907375	HELU-S-RK-CU-UL 120-20	120,0	21,0	15,0	35,0	60,0	-	89,0	25	-
907376	HELU-S-RK-CU-UL 150-8	150,0	8,4	16,8	31,0	55,5	-	78,9	25	-
907377	HELU-S-RK-CU-UL 150-10	150,0	10,5	16,8	31,0	56,5	-	83,7	25	-
907378	HELU-S-RK-CU-UL 150-12	150,0	13,0	16,8	31,0	56,0	-	80,7	25	-
907379	HELU-S-RK-CU-UL 150-14	150,0	15,0	16,8	31,0	57,0	-	83,0	25	-
907380	HELU-S-RK-CU-UL 150-16	150,0	17,0	16,8	31,0	58,0	-	83,6	25	-
907381	HELU-S-RK-CU-UL 150-20	150,0	21,0	16,8	35,0	63,0	-	87,5	25	-
907382	HELU-S-RK-CU-UL 185-8	185,0	8,4	19,0	35,0	58,0	-	103,7	25	-
907383	HELU-S-RK-CU-UL 185-10	185,0	10,5	19,0	35,0	59,0	-	106,1	25	-
907384	HELU-S-RK-CU-UL 185-12	185,0	13,0	19,0	35,0	58,5	-	106,0	25	-
907385	HELU-S-RK-CU-UL 185-14	185,0	15,0	19,0	35,0	61,0	-	107,2	25	-
907386	HELU-S-RK-CU-UL 185-16	185,0	17,0	19,0	35,0	63,0	-	108,6	25	-
907387	HELU-S-RK-CU-UL 185-20	185,0	21,0	19,0	35,0	66,0	-	113,3	25	-
907388	HELU-S-RK-CU-UL 240-8	240,0	8,4	21,0	38,0	67,0	-	124,0	25	-
907389	HELU-S-RK-CU-UL 240-10	240,0	10,5	21,0	38,0	67,0	-	129,7	25	-
907390	HELU-S-RK-CU-UL 240-12	240,0	13,0	21,0	38,0	67,0	-	130,2	25	-
907391	HELU-S-RK-CU-UL 240-14	240,0	15,0	21,0	38,0	69,0	-	133,6	25	-
907392	HELU-S-RK-CU-UL 240-16	240,0	17,0	21,0	38,0	69,5	-	135,6	20	-
907393	HELU-S-RK-CU-UL 240-20	240,0	21,0	21,0	38,0	71,0	-	138,0	25	-
907394	HELU-S-RK-CU-UL 300-10	300,0	10,5	24,0	44,0	79,5	-	204,5	20	-
907395	HELU-S-RK-CU-UL 300-12	300,0	13,0	24,0	44,0	82,0	-	211,8	20	-
907396	HELU-S-RK-CU-UL 300-14	300,0	15,0	24,0	44,0	84,0	-	221,9	20	-
907397	HELU-S-RK-CU-UL 300-16	300,0	17,0	24,0	44,0	85,0	-	219,4	20	-
907398	HELU-S-RK-CU-UL 300-20	300,0	21,0	24,0	44,0	85,0	-	224,0	20	-
907399	HELU-S-RK-CU-UL 400-10	400,0	10,5	27,5	49,0	92,0	-	279,0	15	-
907400	HELU-S-RK-CU-UL 400-12	400,0	13,0	27,5	49,0	92,0	-	278,5	15	-
907401	HELU-S-RK-CU-UL 400-16	400,0	17,0	27,5	49,0	92,0	-	276,5	15	-
907402	HELU-S-RK-CU-UL 400-20	400,0	21,0	27,5	49,0	92,0	-	266,1	15	-
907403	HELU-S-RK-CU-UL 500-12	500,0	13,0	31,0	55,5	113,0	-	493,8	5	-
907404	HELU-S-RK-CU-UL 500-16	500,0	17,0	31,0	55,5	113,0	-	493,8	5	-
907405	HELU-S-RK-CU-UL 500-20	500,0	21,0	31,0	55,5	113,0	-	485,6	5	-
907406	HELU-S-RK-CU-UL 630-16	630,0	17,0	34,0	60,0	115,0	-	513,5	5	-
907407	HELU-S-RK-CU-UL 630-20	630,0	21,0	34,0	60,0	115,0	-	506,0	5	-

Dimensions and specifications may be changed without prior notice.



# HELU-S-RK-45-CU Copper tubular cable lug - 45° angled



## Tubular cable lug angled HELU-S-RK-45-CU

Non-insulated tubular cable lugs in eye type design, 45° angled.

### Material

Socket: Copper according to DIN EN 13600  
Surface: tin plated

### Technical data

Temperature range: up to +120°C

### Note

Compression instruction and instruction for assembly see chapter "Technical information".

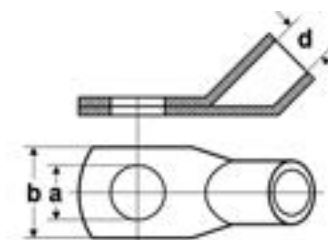

### Dimensions

- a Diameter of the boring
- d Inner diameter of the cable insertion
- b Flange width

### eye type

Part no. 45°	Type	Cross-section mm <sup>2</sup>	a mm	d mm	b mm	Weight kg / 1000 items	Unit
907600	HELU-S-RK-45-CU 10-10	10,0	10,5	4,5	18,0	6,6	100
907478	HELU-S-RK-45-CU 50-6	50,0	6,4	10,0	20,0	29,4	50
907488	HELU-S-RK-45-CU 95-16	95,0	17,0	13,5	28,0	68,0	25
907493	HELU-S-RK-45-CU 150-8	150,0	8,4	16,8	31,0	113,1	25
907497	HELU-S-RK-45-CU 150-20	150,0	21,0	16,8	35,0	101,2	25
907505	HELU-S-RK-45-CU 300-12	300,0	13,0	24,0	43,0	257,0	15
907506	HELU-S-RK-45-CU 300-16	300,0	17,0	24,0	43,0	256,8	15
907507	HELU-S-RK-45-CU 300-20	300,0	21,0	24,0	43,0	273,0	15

Dimensions and specifications may be changed without prior notice.

# HELU-S-RK-45-CU-UL Copper tubular cable lug - 45° angled



## Tubular cable lug angled

### HELU-S-RK-45-CU-UL

Non-insulated tubular cable lugs in eye type design, 45° angled.

## Material

Socket: Copper according to DIN EN 13600  
Surface: tin plated

## Technical data

Temperature range: up to +120°C

## Note

Compression instruction and instruction for assembly see chapter "Technical information".

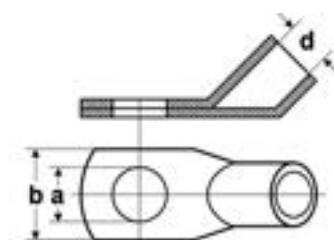

## Dimensions

- a Diameter of the boring
- d Inner diameter of the cable insertion
- b Flange width

## eye type

Part no. 45°	Type	Cross-section mm <sup>2</sup>	a mm	d mm	b mm	Weight kg / 1000 items	Unit
907597	HELU-S-RK-45-CU-UL 10-5	10,0	5,3	4,5	12,0	5,5	100
907598	HELU-S-RK-45-CU-UL 10-6	10,0	6,4	4,5	12,0	5,8	100
907599	HELU-S-RK-45-CU-UL 10-8	10,0	8,4	4,5	15,0	6,5	100
907601	HELU-S-RK-45-CU-UL 16-5	16,0	5,3	5,5	12,0	9,5	100
907467	HELU-S-RK-45-CU-UL 16-6	16,0	6,4	5,5	12,0	10,2	100
907468	HELU-S-RK-45-CU-UL 16-8	16,0	8,4	5,5	15,0	11,7	100
907469	HELU-S-RK-45-CU-UL 16-10	16,0	10,5	5,5	18,0	11,7	100
907470	HELU-S-RK-45-CU-UL 25-6	25,0	6,4	7,0	15,0	13,9	100
907471	HELU-S-RK-45-CU-UL 25-8	25,0	8,4	7,0	16,0	15,1	100
907472	HELU-S-RK-45-CU-UL 25-10	25,0	10,5	7,0	18,0	16,6	100
907473	HELU-S-RK-45-CU-UL 25-12	25,0	13,0	7,0	20,0	17,0	100
907474	HELU-S-RK-45-CU-UL 35-6	35,0	6,4	8,5	17,0	21,7	50
907475	HELU-S-RK-45-CU-UL 35-8	35,0	8,4	8,5	17,0	22,3	50
907476	HELU-S-RK-45-CU-UL 35-10	35,0	10,5	8,5	20,0	23,4	50
907477	HELU-S-RK-45-CU-UL 35-12	35,0	13,0	8,5	22,0	24,0	50
907479	HELU-S-RK-45-CU-UL 50-8	50,0	8,4	10,0	20,0	33,4	50
907480	HELU-S-RK-45-CU-UL 50-10	50,0	10,5	10,0	20,0	36,5	50
907481	HELU-S-RK-45-CU-UL 50-12	50,0	13,0	10,0	23,0	36,5	50
907482	HELU-S-RK-45-CU-UL 70-8	70,0	8,4	12,0	24,0	49,0	25
907483	HELU-S-RK-45-CU-UL 70-10	70,0	10,5	12,0	24,0	52,3	25
907484	HELU-S-RK-45-CU-UL 70-12	70,0	13,0	12,0	24,0	53,4	25
907485	HELU-S-RK-45-CU-UL 95-8	95,0	8,4	13,5	26,0	61,8	25
907486	HELU-S-RK-45-CU-UL 95-10	95,0	10,5	13,5	26,0	62,0	25
907487	HELU-S-RK-45-CU-UL 95-12	95,0	13,0	13,5	26,0	62,0	25
907489	HELU-S-RK-45-CU-UL 120-8	120,0	8,4	15,0	29,0	78,0	25
907490	HELU-S-RK-45-CU-UL 120-10	120,0	10,5	15,0	29,0	89,0	25
907491	HELU-S-RK-45-CU-UL 120-12	120,0	13,0	15,0	29,0	89,1	25
907492	HELU-S-RK-45-CU-UL 120-16	120,0	17,0	15,0	30,0	93,1	25
907494	HELU-S-RK-45-CU-UL 150-10	150,0	10,5	16,8	31,0	98,0	25
907495	HELU-S-RK-45-CU-UL 150-12	150,0	13,0	16,8	31,0	96,8	25
907496	HELU-S-RK-45-CU-UL 150-16	150,0	17,0	16,8	31,0	101,2	25
907498	HELU-S-RK-45-CU-UL 185-10	185,0	10,5	19,0	35,0	123,5	20
907499	HELU-S-RK-45-CU-UL 185-12	185,0	13,0	19,0	35,0	122,4	20
907500	HELU-S-RK-45-CU-UL 185-16	185,0	17,0	19,0	35,0	128,4	20
907501	HELU-S-RK-45-CU-UL 185-20	185,0	21,0	19,0	35,0	139,9	20
907502	HELU-S-RK-45-CU-UL 240-12	240,0	13,0	21,0	38,0	154,6	15
907503	HELU-S-RK-45-CU-UL 240-16	240,0	17,0	21,0	38,0	165,1	15
907504	HELU-S-RK-45-CU-UL 240-20	240,0	21,0	21,0	38,0	170,4	15

Dimensions and specifications may be changed without prior notice.

# HELU-S-RK-90-CU-UL Copper tubular cable lug - 90° angled



## Tubular cable lug angled HELU-S-RK-90-CU-UL

Non-insulated tubular cable lugs in eye type design, 90° angled.

### Material

Socket: Copper according to DIN EN 13600  
Surface: tin plated

### Technical data

Temperature range: up to +120°C

### Note

Compression instruction and instruction for assembly see chapter "Technical information".

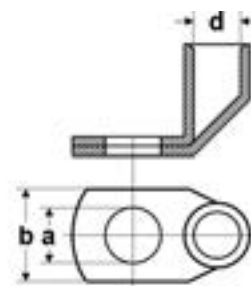

### Dimensions

- a Diameter of boring
- d Inner diameter of the cable insertion
- b Flange width

### eye type

Part no. 90°	Type	Cross-section mm <sup>2</sup>	a mm	d mm	b mm	Weight kg / 1000 items	Unit	
907508	HELU-S-RK-90-CU-UL 6-5	6,0	5,3	3,5	11,0	5,6	100	-
907509	HELU-S-RK-90-CU-UL 6-6	6,0	6,4	3,5	11,0	6,2	100	-
907510	HELU-S-RK-90-CU-UL 6-8	6,0	8,4	3,5	15,0	6,4	100	-
907511	HELU-S-RK-90-CU-UL 6-10	6,0	10,5	3,5	18,0	6,8	100	-
907512	HELU-S-RK-90-CU-UL 6-12	6,0	13,0	3,5	20,0	6,6	100	-
907513	HELU-S-RK-90-CU-UL 10-5	10,0	5,3	4,5	12,0	5,4	100	-
907514	HELU-S-RK-90-CU-UL 10-6	10,0	6,4	4,5	12,0	5,9	100	-
907515	HELU-S-RK-90-CU-UL 10-8	10,0	8,4	4,5	15,0	6,7	100	-
907516	HELU-S-RK-90-CU-UL 10-10	10,0	10,5	4,5	18,0	7,0	100	-
907517	HELU-S-RK-90-CU-UL 10-12	10,0	13,0	4,5	20,0	7,0	100	-
907518	HELU-S-RK-90-CU-UL 16-5	16,0	5,3	5,5	12,0	10,7	100	-
907519	HELU-S-RK-90-CU-UL 16-6	16,0	6,4	5,5	12,0	11,5	100	-
907520	HELU-S-RK-90-CU-UL 16-8	16,0	8,4	5,5	15,0	12,0	100	-
907521	HELU-S-RK-90-CU-UL 16-10	16,0	10,5	5,5	18,0	12,3	100	-
907522	HELU-S-RK-90-CU-UL 16-12	16,0	13,0	5,5	20,0	12,3	100	-
907523	HELU-S-RK-90-CU-UL 25-6	25,0	6,4	7,0	15,0	13,5	100	-
907524	HELU-S-RK-90-CU-UL 25-8	25,0	8,4	7,0	16,0	14,3	100	-
907525	HELU-S-RK-90-CU-UL 25-10	25,0	10,5	7,0	18,0	15,7	100	-
907526	HELU-S-RK-90-CU-UL 25-12	25,0	13,0	7,0	20,0	15,1	100	-
907527	HELU-S-RK-90-CU-UL 35-6	35,0	6,4	8,5	17,0	21,0	100	-
907528	HELU-S-RK-90-CU-UL 35-8	35,0	8,4	8,5	17,0	23,1	100	-
907529	HELU-S-RK-90-CU-UL 35-10	35,0	10,5	8,5	20,0	23,6	100	-
907530	HELU-S-RK-90-CU-UL 35-12	35,0	13,0	8,5	22,0	23,7	100	-
907531	HELU-S-RK-90-CU-UL 35-16	35,0	17,0	8,5	28,0	24,8	100	-
907532	HELU-S-RK-90-CU-UL 50-6	50,0	6,4	10,0	20,0	30,0	100	-
907533	HELU-S-RK-90-CU-UL 50-8	50,0	8,4	10,0	20,0	32,2	100	-
907534	HELU-S-RK-90-CU-UL 50-10	50,0	10,5	10,0	20,0	33,2	100	-
907535	HELU-S-RK-90-CU-UL 50-12	50,0	13,0	10,0	23,0	32,8	100	-
907536	HELU-S-RK-90-CU-UL 50-16	50,0	17,0	10,0	27,0	36,3	100	-
907537	HELU-S-RK-90-CU-UL 50-20	50,0	21,0	10,0	30,0	38,9	100	-
907538	HELU-S-RK-90-CU-UL 70-6	70,0	6,4	12,0	24,0	44,1	25	-
907539	HELU-S-RK-90-CU-UL 70-8	70,0	8,4	12,0	24,0	48,6	25	-
907540	HELU-S-RK-90-CU-UL 70-10	70,0	10,5	12,0	24,0	50,6	25	-
907541	HELU-S-RK-90-CU-UL 70-12	70,0	13,0	12,0	24,0	49,4	25	-
907542	HELU-S-RK-90-CU-UL 70-16	70,0	17,0	12,0	28,0	51,1	25	-
907543	HELU-S-RK-90-CU-UL 70-20	70,0	21,0	12,0	29,0	52,6	25	-

Continuation ▶

# HELU-S-RK-90-CU-UL Copper tubular cable lug - 90° angled



## eye type

Part no. 90°	Type	Cross-section mm <sup>2</sup>	a mm	d mm	b mm	Weight kg / 1000 items	Unit	
907544	HELU-S-RK-90-CU-UL 95-8	95,0	8,4	13,5	26,0	53,3	25	-
907545	HELU-S-RK-90-CU-UL 95-10	95,0	10,5	13,5	26,0	55,9	25	-
907546	HELU-S-RK-90-CU-UL 95-12	95,0	13,0	13,5	26,0	56,6	25	-
907547	HELU-S-RK-90-CU-UL 95-16	95,0	17,0	13,5	28,0	60,0	25	-
907548	HELU-S-RK-90-CU-UL 120-8	120,0	8,4	15,0	29,0	76,3	25	-
907549	HELU-S-RK-90-CU-UL 120-10	120,0	10,5	15,0	29,0	80,7	25	-
907550	HELU-S-RK-90-CU-UL 120-12	120,0	13,0	15,0	29,0	79,9	25	-
907551	HELU-S-RK-90-CU-UL 120-16	120,0	17,0	15,0	30,0	84,6	25	-
907552	HELU-S-RK-90-CU-UL 150-8	150,0	8,4	16,8	31,0	80,3	25	-
907553	HELU-S-RK-90-CU-UL 150-10	150,0	10,5	16,8	31,0	80,7	25	-
907554	HELU-S-RK-90-CU-UL 150-12	150,0	13,0	16,8	31,0	82,9	25	-
907555	HELU-S-RK-90-CU-UL 150-16	150,0	17,0	16,8	31,0	85,0	25	-
907556	HELU-S-RK-90-CU-UL 150-20	150,0	21,0	16,8	35,0	88,9	25	-
907557	HELU-S-RK-90-CU-UL 185-10	185,0	10,5	19,0	35,0	114,1	25	-
907558	HELU-S-RK-90-CU-UL 185-12	185,0	13,0	19,0	35,0	120,4	25	-
907559	HELU-S-RK-90-CU-UL 185-16	185,0	17,0	19,0	35,0	124,8	25	-
907560	HELU-S-RK-90-CU-UL 185-20	185,0	21,0	19,0	35,0	127,0	25	-
907561	HELU-S-RK-90-CU-UL 240-10	240,0	10,5	21,0	38,0	133,2	25	-
907562	HELU-S-RK-90-CU-UL 240-12	240,0	13,0	21,0	38,0	134,0	25	-
907563	HELU-S-RK-90-CU-UL 240-16	240,0	17,0	21,0	38,0	137,6	25	-
907564	HELU-S-RK-90-CU-UL 240-20	240,0	21,0	21,0	38,0	142,3	25	-
907565	HELU-S-RK-90-CU-UL 300-12	300,0	13,0	24,0	43,0	199,2	20	-
907566	HELU-S-RK-90-CU-UL 300-16	300,0	17,0	24,0	43,0	209,0	20	-
907567	HELU-S-RK-90-CU-UL 300-20	300,0	21,0	24,0	43,0	218,1	20	-

Dimensions and specifications may be changed without prior notice.

# HELU-S-PK-AL-DIN Tubular compression cable lugs

uninsulated



## Compression cable lug HELU-S-PK-AL-DIN

Uninsulated, straight tubular cable lug in eye type design made of aluminium. High quality version for reliable crimping. Designed for conductor type RM acc. to DIN 48201 and circular reshaped conductors.

## Material

AL 99,5  
Surface: bare

## Note

Code type indicates the required hexagonal crimping insert.  
Sleeves are prefilled with contact grease and sealed with plastic plug  
Compression instruction and instruction for assembly see chapter "Technical information".

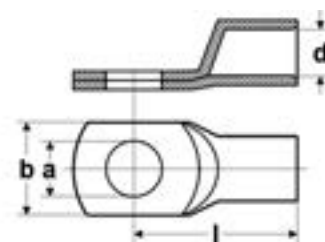

## Dimensions

a Diameter of the bore  
d Inner diameter of the cable inclusion  
b Flange width  
l Length to middle of the bore

## eye type

Part no.	Type	Cross-section RM/SM - SE mm <sup>2</sup>	a mm	d mm	b mm	l mm	Code type	Weight kg / 1000 items	Unit
907865	HELU-S-PK-AL-DIN 16-8	16,0 - 25,0	8,4	5,6	16,0	52,0	12	9,6	50
907866	HELU-S-PK-AL-DIN 16-10	16,0 - 25,0	10,5	5,6	18,0	52,0	12	9,7	50
907867	HELU-S-PK-AL-DIN 25-8	25,0 - 35,0	8,4	6,8	16,0	60,0	12	14,8	50
907868	HELU-S-PK-AL-DIN 25-10	25,0 - 35,0	10,5	6,8	18,0	60,0	12	15,3	50
907869	HELU-S-PK-AL-DIN 35-8	35,0 - 50,0	8,4	8,0	20,0	67,0	14	24,5	50
907870	HELU-S-PK-AL-DIN 35-10	35,0 - 50,0	10,5	8,0	20,0	67,0	14	24,5	50
907871	HELU-S-PK-AL-DIN 35-12	35,0 - 50,0	13,0	8,0	20,0	67,0	14	23,5	50
907872	HELU-S-PK-AL-DIN 50-8	50,0 - 70,0	8,4	10,0	23,0	74,0	16	32,9	25
907873	HELU-S-PK-AL-DIN 50-10	50,0 - 70,0	10,5	10,0	23,0	74,0	16	28,8	25
907874	HELU-S-PK-AL-DIN 50-12	50,0 - 70,0	13,0	10,0	23,0	74,0	16	33,8	25
907875	HELU-S-PK-AL-DIN 70-10	70,0 - 95,0	10,5	11,5	28,0	84,0	18	47,7	25
907876	HELU-S-PK-AL-DIN 70-12	70,0 - 95,0	13,0	11,5	28,0	87,0	18	47,3	25
907877	HELU-S-PK-AL-DIN 95-10	95,0 - 120,0	10,5	13,2	32,0	90,0	22	70,1	10
907878	HELU-S-PK-AL-DIN 95-12	95,0 - 120,0	13,0	13,2	32,0	90,0	22	78,2	10
907879	HELU-S-PK-AL-DIN 95-16	95,0 - 120,0	17,0	13,2	32,0	90,0	22	76,2	10
907880	HELU-S-PK-AL-DIN 120-10	120,0 - 150,0	10,5	14,7	32,0	98,0	22	83,8	10
907881	HELU-S-PK-AL-DIN 120-12	120,0 - 150,0	13,0	14,7	32,0	98,0	22	87,9	10
907882	HELU-S-PK-AL-DIN 120-16	120,0 - 150,0	17,0	14,7	32,0	98,0	22	86,4	10
906459	HELU-S-PK-AL-DIN 150-10	150,0 - 185,0	10,5	16,3	35,0	104,0	25	99,8	10
906436	HELU-S-PK-AL-DIN 150-12	150,0 - 185,0	13,0	16,3	35,0	104,0	25	102,3	10
906461	HELU-S-PK-AL-DIN 150-16	150,0 - 185,0	17,0	16,3	35,0	104,0	25	100,8	10
906462	HELU-S-PK-AL-DIN 150-20	150,0 - 185,0	21,0	16,3	35,0	104,0	25	100,2	10
907883	HELU-S-PK-AL-DIN 185-10	185,0 - 240,0	10,5	18,5	40,0	109,0	28	133,9	10
906463	HELU-S-PK-AL-DIN 185-12	185,0 - 240,0	13,0	18,5	40,0	109,0	28	133,9	10
906464	HELU-S-PK-AL-DIN 185-16	185,0 - 240,0	17,0	18,5	40,0	109,0	28	137,5	10
906465	HELU-S-PK-AL-DIN 185-20	185,0 - 240,0	21,0	18,5	40,0	109,0	28	137,5	10
907884	HELU-S-PK-AL-DIN 240-10	240,0 - 300,0	10,5	21,0	46,0	119,0	32	182,8	10
906466	HELU-S-PK-AL-DIN 240-12	240,0 - 300,0	13,0	21,0	46,0	119,0	32	179,4	10
906467	HELU-S-PK-AL-DIN 240-16	240,0 - 300,0	17,0	21,0	46,0	119,0	32	176,2	10
906468	HELU-S-PK-AL-DIN 240-20	240,0 - 300,0	21,0	21,0	46,0	119,0	32	179,0	10
906469	HELU-S-PK-AL-DIN 300-12	300,0	13,0	23,3	50,0	125,0	34	205,4	5
906470	HELU-S-PK-AL-DIN 300-16	300,0	17,0	23,3	50,0	125,0	34	201,4	5
906471	HELU-S-PK-AL-DIN 300-20	300,0	21,0	23,3	50,0	125,0	34	194,3	5
906472	HELU-S-PK-AL-DIN 400-12	400,0	13,0	26,0	55,0	120,0	38	283,0	5
906473	HELU-S-PK-AL-DIN 400-16	400,0	17,0	26,0	55,0	120,0	38	273,3	5
906474	HELU-S-PK-AL-DIN 400-20	400,0	21,0	26,0	55,0	120,0	38	240,0	5
906475	HELU-S-PK-AL-DIN 500-12	500,0	13,0	29,0	63,0	140,0	44	380,0	5
906476	HELU-S-PK-AL-DIN 500-16	500,0	17,0	29,0	63,0	140,0	44	378,0	5
906477	HELU-S-PK-AL-DIN 500-20	500,0	21,0	29,0	63,0	140,0	44	373,5	5

Dimensions and specifications may be changed without prior notice.

# HELU-S-PK-AL-FG compression cable lug, FG, extruded, straight ring design



## Technical Data

**Material:** Aluminium AL 99,5  
**Surface:** bright or tinned  
**Special feature:** smaller connecting flange (b) than DIN compression cable lugs

## Note

- Sleeve filled with contact lubricant and closed against drying out
- Strain-relieved for aluminum conductors
- DIN 46329

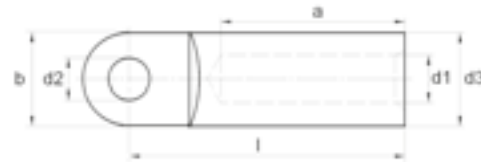

## HELU-S-PK-AL-FG

Part No. bright	Part No. tinned	Cross section mm <sup>2</sup> rm/sm*	Hole M	Key Figures	Dimensions in mm					
					d1	d3	d2	b	l	a
909835	909853	16*	8	12	5,8		8,4	20	53	30
909836	909854	16	10	12	5,8		10,5	20	53	30
909837	909855	25	8	12	6,8		8,4	25	53	30
909838	909856	25	10	12	6,8		10,5	25	53	30
909839	909857	25	12	12	6,8		13	25	53	30
909840	909858	35	8	14	8		8,4	25	65	42
909841	909859	35	10	14	8		10,5	25	65	42
909842	909860	35	12	14	8		13	25	65	42
909843	909861	50	8	16	9,8		8,4	25	65	42
909844	909862	50	10	16	9,8		10,5	25	65	42
909845	909863	50	12	16	9,8		13	25	65	42
909846	909864	70	8	18	11,2		8,4	25	75	52
909847	909865	70	10	18	11,2		10,5	25	75	52
909848	909866	70	12	18	11,2		13	25	75	52
909849	909867	95	8	22	13,2	22	8,4	25	81	56
906539	906562	95	10	22	13,2	22	10,5	25	81	56
906540	906563	95	12	22	13,2	22	13	25	81	56
906541	906564	120	10	22	14,7	23	10,5	30	86	56
906542	906565	120	12	22	14,7	23	13	30	86	56
906543	906566	120	16	22	14,7	23	17	30	86	56
906544	906567	150	10	25	16,3	25	10,5	30	90	60
906545	906568	150	12	25	16,3	25	13	30	90	60
906546	906569	150	16	25	16,3	25	17	30	90	60
909850	909868	150	20	25	16,3	25	21	25	90	60
906547	906570	185	10	28	18,3	28,5	10,5	30	91	60
906548	906571	185	12	28	18,3	28,5	13	30	91	60
906549	906572	185	16	28	18,3	28,5	17	30	91	60
909851	909869	185	20	28	18,3	28,5	21	25	91	60
909852	909870	240	10	32	21	32	10,5	38	106	70
906550	906573	240	12	32	21	32	13	38	106	70
906551	906574	240	16	32	21	32	17	38	106	70
906552	906575	240	20	32	21	32	21	38	106	70
906553	906576	300	12	34	23,3	34	13	38	106	70
906554	906577	300	16	34	23,3	34	17	38	106	70
906555	906578	300	20	34	23,3	34	21	38	106	70
906556	906579	400	12	38	26	38,5	13	38	116	73
906557	906580	400	16	38	26	38,5	17	38	116	73
906558	906581	400	20	38	26	38,5	21	38	116	73
906559	906582	500	12	44	29	44	13	44	122	79
906560	906583	500	16	44	29	44	17	44	122	79
906561	906584	500	20	44	29	44	21	44	122	79

rm = round cable multi-wire  
sm = sector cable multi-wire

\* not normed

Other dimensions available on request. Subject to technical changes. Prices available on request.

\* Please observe: Processing must be done exclusively with the C8 compression die intended for it. Only then can you achieve the required pull-out values according to DIN EN 61238 Part 1. The key figures on the compression cable lug and the compression die must match.

# HELU-S-PK-AL/CU Aluminium / Copper compression cable lug – straight



## Compression cable lug HELU-S-PK-AL/CU

Non-insulated, straight compression lug in eye type design made of aluminium. High quality version for reliable crimping. Designed for conductor type RM and circularly reshaped conductors.

### Material

Socket: Al 99,5 and Cu acc. to DIN EN 13601  
Surface: bare

### Note

Code type indicates the required hexagonal crimping insert.  
Al-sleeves are prefilled with contact grease and sealed with plastic plugs  
Compression instruction and instruction for assembly see chapter "Technical information".

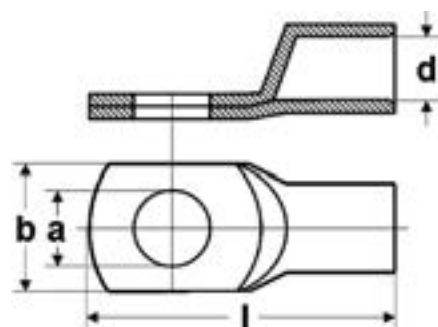

### Dimensions

a Diameter of the boring  
d Inner diameter of the cable inclusion  
b Flange width  
l Length

### eye type

Part no.	Cross-section RM/SM - SE mm <sup>2</sup>	Boring M	a mm	d mm	b mm	l mm	Code type	Weight kg / 1000 items	Unit	
907568	10 - -	8	8,4	5,0	20,0	50,0	10	26,5	25	-
907569	16 - 25	8	8,4	5,6	20,0	60,0	12	35,4	25	-
907570	16 - 25	10	10,5	5,6	20,0	60,0	12	34,2	25	-
907571	25 - 35	8	8,4	6,8	20,0	65,0	12	35,7	25	-
907572	25 - 35	10	10,5	6,8	20,0	65,0	12	34,4	25	-
907573	25 - 35	12	13,0	6,8	26,0	67,0	12	44,5	25	-
907574	35 - 50	8	8,4	8,0	20,0	75,0	14	45,5	25	-
907575	35 - 50	10	10,5	8,0	20,0	75,0	14	44,2	25	-
907576	35 - 50	12	13,0	8,0	26,0	75,0	14	51,5	25	-
907577	50 - 70	8	8,4	9,8	20,0	75,0	16	48,7	25	-
907578	50 - 70	10	10,5	9,8	20,0	75,0	16	47,2	25	-
907579	50 - 70	12	13,0	9,8	26,0	75,0	16	59,9	25	-
907580	70 - 95	8	8,4	11,2	26,0	85,0	18	61,9	10	-
907581	70 - 95	0	10,5	11,2	26,0	10,0	18	73,7	10	-
907582	70 - 95	0	13,0	11,2	26,0	85,0	18	73,7	10	-
907583	70 - 95	16	17,0	11,2	30,0	88,0	18	81,0	10	-
907584	95 - 120	8	8,4	13,2	26,0	86,0	22	102,9	10	-
907585	95 - 120	10	10,5	13,2	26,0	86,0	22	105,9	10	-
907586	95 - 120	12	13,0	13,2	26,0	86,0	22	103,4	10	-
907587	95 - 120	16	17,0	13,2	30,0	88,0	22	109,9	10	-
907588	120 - 150	8	8,4	14,7	26,0	88,0	22	106,8	10	-
907589	120 - 150	10	10,5	14,7	26,0	88,0	22	106,8	10	-
907590	120 - 150	12	13,0	14,7	26,0	88,0	22	104,5	10	-
907591	120 - 150	16	17,0	14,7	30,0	90,0	22	114,5	10	-
907592	150 - 185	8	8,4	16,3	30,0	100,0	25	138,8	5	-
906478	150 - 185	10	10,5	16,3	30,0	100,0	25	138,0	5	-
906172	150 - 185	12	13,0	16,3	30,0	100,0	25	135,7	5	-
906173	150 - 185	16	17,0	16,3	30,0	100,0	25	128,8	5	-
907593	185 - 240	8	8,4	18,3	30,0	102,0	28	183,7	5	-
906479	185 - 240	10	10,5	18,3	30,0	102,0	28	176,1	5	-
906480	185 - 240	12	13,0	18,3	30,0	102,0	28	173,1	5	-
906481	185 - 240	16	17,0	18,3	36,0	105,0	28	196,8	5	-
906482	185 - 240	8	21,0	18,3	36,0	105,0	28	189,7	5	-
906483	240 - 300	10	10,5	21,0	30,0	112,0	32	204,1	5	-
906185	240 - 300	12	13,0	21,0	30,0	112,0	32	204,1	5	-
906484	240 - 300	16	17,0	21,0	36,0	115,0	32	225,8	5	-
906485	240 - 300	20	21,0	21,0	36,0	115,0	32	218,5	5	-

Continuation ▶

# HELU-S-PK-AL/CU Aluminium / Copper compression cable lug – straight

## eye type

Part no.	Cross-section RM/SM - SE mm <sup>2</sup>	Boring M	a mm	d mm	b mm	l mm	Code type	Weight kg / 1000 items	Unit	
906486	300 - -	10	10,5	23,3	30,0	115,0	34	218,4	5	-
906487	300 - -	12	13,0	23,3	30,0	116,0	34	226,4	5	-
906488	300 - -	16	17,0	23,3	36,0	116,0	34	232,2	5	-
906489	300 - -	20	21,0	23,3	36,0	116,0	34	225,0	5	-
906490	400 - -	10	10,5	26,0	36,0	125,0	38	328,7	5	-
906212	400 - -	12	13,0	26,0	36,0	125,0	38	332,7	5	-
906174	400 - -	16	17,0	26,0	36,0	125,0	38	352,6	5	-
906175	400 - -	20	21,0	26,0	36,0	125,0	38	341,5	5	-
906491	500 - -	10	10,5	29,0	44,0	140,0	44	437,1	1	-
906492	500 - -	12	13,0	29,0	44,0	140,0	44	433,3	1	-
906493	500 - -	16	17,0	29,0	44,0	140,0	44	428,3	1	-
906494	500 - -	20	21,0	29,0	44,0	140,0	44	420,8	1	-
907594	625 - -	12	13,0	35,0	50,0	177,0	52	630,1	1	-
907595	625 - -	16	17,0	35,0	50,0	177,0	52	770,0	1	-
907596	625 - -	20	21,0	35,0	50,0	177,0	52	763,0	1	-

Dimensions and specifications may be changed without prior notice.



# KAC-U AL/CU-bi-metallic washer



## Washer KAC-U

Bi-metallic washer for the processing of aluminium-copper materials.  
Only for use in dry areas.

## Material

E-Al, one side copper plated

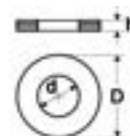

## Dimensions

D Outer diameter  
d Inner diameter  
h Height

Part no.	Size	Inner Ø mm	Outer Ø mm	Thickness mm	Unit	
906049	M8 x 1,5	8,5	18,0	1,0	10	-
906050	M10 x 1,5	11,0	22,0	2,0	10	-
906051	M12 x 1,5	13,0	28,0	2,0	10	-
906052	M14 x 1,5	15,0	28,0	2,0	10	-
906053	M16 x 1,5	17,0	35,0	2,0	10	-

Dimensions and specifications may be changed without prior notice.

# HELU-S-PV-AL-DIN Aluminium press connector



## Press connector HELU-S-PV-AL-DIN

Press connector for strain-relieved connections of conductors designed acc. to DIN 46267 part 2.

## Material

Socket: Al 99,5  
Surface: bare

## Technical data

Temperature range: up to +120°C

## Note

- Code type indicates the required hexagonal crimping insert.
- Part No. 907835 is not standardized.
- Sleeves are prefilled with contact grease and sealed with plastic plug.

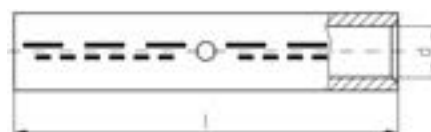

## Dimensions

d Inner diameter of the cable inclusion  
l Length

## blank

Part no.	Cross-section RM/SM - SE mm <sup>2</sup>	d mm	l mm	Code type	Weight kg / 1000 items	Unit	
907835	16 - 25	5,6	55,0	12	13,4	50	-
906511	25 - 35	6,8	70,0	12	15,4	50	-
906512	35 - 50	8,0	85,0	14	28,5	50	-
906513	50 - 70	10,0	85,0	16	34,0	25	-
906514	70 - 95	11,5	105,0	18	55,9	25	-
906515	95 - 120	13,2	105,0	22	82,1	10	-
906516	120 - 150	14,7	105,0	22	86,4	10	-
906406	150 - 185	16,3	125,0	25	111,3	10	-
906517	185 - 240	18,5	125,0	28	143,5	10	-
906518	240 - 300	21,0	145,0	32	191,7	10	-
906519	300 - -	23,3	145,0	34	227,1	10	-
906520	400 - -	26,0	210,0	38	359,0	5	-
906521	500 - -	29,0	210,0	44	455,0	5	-

Dimensions and specifications may be changed without prior notice.

# HELU-S-PV-AL/CU Aluminium / Copper press connector



## Press Connector HELU-S-PV-AL/CU

Press connector for aluminium conductors, strain relieved

## Material

Socket: Al 99,5 and Cu acc. to DIN EN 13601  
Surface: bare

## Note

Al-sleeves are prefilled with contact grease and sealed with plastic plug.

## Technical data

Temperature range: up to +120°C



## Dimensions

- d1 Inner diameter of the cable inclusion, copper side
- d2 Inner diameter of the cable inclusion, aluminium side
- l Length

## blank

Part no.	Cross-section AL RM/SM - SE mm <sup>2</sup>	Cross-section CU SE mm <sup>2</sup>	Code type AL / CU	d1 CU mm	d2 AL mm	l mm	Weight kg / 1000 items	Unit	
907836	16 - 25	6	12 / 5	3,7	5,6	45,0	9,2	25	-
907837	16 - 25	10	12 / 6	4,4	5,6	45,0	9,4	25	-
907838	16 - 25	16	12 / 8	5,5	5,6	56,0	15,8	25	-
907839	25 - 35	10	12 / 6	4,4	6,8	51,0	9,9	25	-
907840	25 - 35	16	12 / 8	5,5	6,8	61,0	16,1	25	-
907841	25 - 35	25	12 / 10	7,0	6,8	62,0	19,2	25	-
907842	35 - 50	16	14 / 8	5,5	8,0	71,0	21,2	25	-
907843	35 - 50	25	14 / 10	7,0	8,0	71,0	24,1	25	-
907844	35 - 50	35	14 / 12	8,2	8,0	70,0	29,9	25	-
907845	50 - 70	25	16 / 10	7,0	9,8	71,5	26,6	25	-
907846	50 - 70	35	16 / 12	8,2	9,8	71,5	33,4	25	-
907847	50 - 70	50	16 / 14	10,0	9,8	71,5	43,5	25	-
907848	70 - 95	25	18 / 10	7,0	11,2	79,0	36,2	10	-
907849	70 - 95	35	18 / 12	8,2	11,2	79,0	42,2	10	-
907850	70 - 95	50	18 / 14	10,0	11,2	85,0	53,3	10	-
907851	70 - 95	70	18 / 16	11,5	11,2	88,0	64,0	10	-
907852	95 - 120	35	22 / 12	8,2	13,2	79,0	57,4	10	-
907853	95 - 120	50	22 / 14	10,0	13,2	85,0	69,1	10	-
907854	95 - 120	70	22 / 26	11,5	13,2	87,0	78,9	10	-
907855	95 - 120	95	22 / 18	13,5	13,2	94,0	98,8	10	-
907856	120 - 150	50	22 / 14	10,0	14,7	87,0	66,5	10	-
907857	120 - 150	70	22 / 16	11,5	14,7	89,0	76,1	10	-
907858	120 - 150	95	22 / 18	13,5	14,7	97,0	97,7	10	-
907859	120 - 150	120	22 / 20	15,5	14,7	98,0	108,3	10	-
906460	150 - 185	70	25 / 16	11,5	16,3	101,0	95,9	5	-
906495	150 - 185	95	25 / 18	13,5	16,3	108,0	116,6	5	-
906209	150 - 185	120	25 / 20	15,5	16,3	108,0	125,9	5	-
906496	150 - 185	150	25 / 22	17,0	16,3	113,0	155,0	5	-
906497	185 - 240	95	28 / 18	13,5	18,3	108,0	130,0	5	-
906498	185 - 240	120	28 / 20	15,5	18,3	108,0	140,1	5	-
906499	185 - 240	150	28 / 22	17,0	18,3	113,0	169,3	5	-
906500	185 - 240	185	28 / 25	19,0	18,3	116,0	185,3	5	-
906501	240 - 300	120	32 / 20	15,5	21,0	120,0	173,6	5	-
906502	240 - 300	150	32 / 22	17,0	21,0	124,0	200,8	5	-
906503	240 - 300	185	32 / 25	19,0	21,0	127,0	218,4	5	-
906504	240 - 300	240	32 / 28	21,5	21,0	132,0	280,0	5	-
906505	300 - -	150	34 / 22	17,0	23,3	124,0	205,1	5	-
906506	300 - -	185	34 / 25	19,0	23,3	128,0	225,8	5	-
906507	300 - -	240	34 / 28	21,5	23,3	134,0	290,0	5	-
906508	300 - -	300	34 / 32	24,5	23,3	144,0	349,0	5	-

Continuation ▶

# HELU-S-PV-AL/CU Aluminium / Copper press connector

blank

Part no.	Cross-section AL RM/SM - SE mm <sup>2</sup>	Cross-section CU SE mm <sup>2</sup>	Code type AL / CU	d1 CU mm	d2 AL mm	l mm	Weight kg / 1000 items	Unit	
906509	400 - -	185	38 / 25	19,0	26,0	131,0	267,0	1	-
906210	400 - -	240	38 / 28	21,5	26,0	135,0	329,0	1	-
906510	400 - -	300	38 / 32	24,5	26,0	145,0	386,0	1	-
907860	500 - -	240	44 / 28	21,5	29,0	145,0	402,0	1	-
907861	500 - -	300	44 / 32	24,5	29,0	155,0	464,1	1	-
907862	500 - -	400	44 / 38	27,5	29,0	173,0	643,6	1	-

Dimensions and specifications may be changed without prior notice.

# HELU-S-PAB-AL-DIN Aluminium Compression Terminal Pin Type



## Aluminium Compression Terminal Pin Type

HELU-S-PAB-AL-DIN

### Material

• Aluminium Alloy 99,5

### Note

- Code type indicates the required hexagonal crimp insert
- AL-sleeves are prefilled with contact grease and sealed with plastic plug

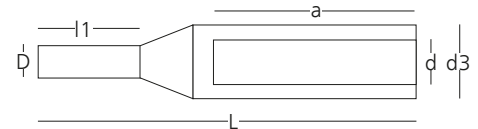

### Dimensions

- a depth of bore
- d inner diameter, tube
- d3 outer diameter, tube
- D outer diameter, pin
- l1 bolt length
- L total length

Part no.	Type	cross section		a	d	d3	D	l1	L	key figures	
		mm	mm <sup>2</sup>							mm	Type
908301	HELU-S-PAB-AL-DIN 50	50	70	41,0	9,8	16,0	8	25	77	16	
908302	HELU-S-PAB-AL-DIN 70	70	95	48,0	11,2	18,5	10	30	89	18	
908303	HELU-S-PAB-AL-DIN 95	95	120	48,0	13,2	22,0	12	33	93	22	
908304	HELU-S-PAB-AL-DIN 120	120	150	49,0	14,7	23,0	13	38	100	22	
908305	HELU-S-PAB-AL-DIN 150	150	185	58,5	16,3	25,0	14	38	110	25	
908306	HELU-S-PAB-AL-DIN 185	185	240	58,5	18,3	28,5	16	44	120	28	
908307	HELU-S-PAB-AL-DIN 240	240	300	69,0	21,0	32,0	18	44	130	32	
908308	HELU-S-PAB-AL-DIN 300	300	-	69,0	23,3	34,0	20	46	132	34	
908309	HELU-S-PAB-AL-DIN 400	400	-	70,0	26,0	38,5	23	52	140	38	
908310	HELU-S-PAB-AL-DIN 500	500	-	80,0	29,0	44,0	26	58	156	44	

# HELU-S-PAB-AL/CU-DIN Bimetallic Compression Terminal Pin Type



## Bimetallic Compression Terminal Pin Type

HELU-S-PAB-AL/CU-DIN

### Material

- Aluminium Alloy 99,5 (tube) and bare copper (pin) according to DIN EN 13601
- Surface: bare

### Note

- Code type indicates the required hexagonal crimp insert
- AL-sleeves are prefilled with contact grease and sealed with plastic plug

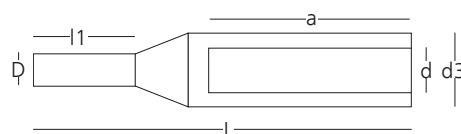

### Dimensions

- a depth of bore
- d inner diameter, tube
- d3 outer diameter, tube
- D outer diameter, pin
- l1 bolt length
- L total length

Part no.	Type	cross section		a	d	d3	D	l1	L	key figures	Weight	Unit
		mm	mm <sup>2</sup>									
908191	HELU-S-PAB-AL/CU-DIN 16	16	35	26,0	5,6	12,0	6	20	56,0	12	15,40	25
908192	HELU-S-PAB-AL/CU-DIN 25	25	35	31,0	6,8	12,0	6	20	61,5	12	16,00	25
908193	HELU-S-PAB-AL/CU-DIN 35	35	50	41,0	8,0	14,0	7	22	72,5	14	25,10	25
908194	HELU-S-PAB-AL/CU-DIN 50	50	70	41,0	9,8	16,0	8	25	78,0	16	34,50	25
908195	HELU-S-PAB-AL/CU-DIN 70	70	95	48,0	11,2	18,5	10	30	92,5	18	57,80	10
908196	HELU-S-PAB-AL/CU-DIN 95	95	120	48,0	13,2	22,0	12	33	95,0	22	86,40	10
908197	HELU-S-PAB-AL/CU-DIN 120	120	150	49,0	14,7	23,0	12	38	105,0	22	96,70	10
908198	HELU-S-PAB-AL/CU-DIN 150	150	185	58,5	16,3	25,0	12	38	117,5	25	115,20	5
908199	HELU-S-PAB-AL/CU-DIN 185	185	240	58,5	18,3	28,5	14	44	124,0	28	167,80	5
908200	HELU-S-PAB-AL/CU-DIN 240	240	300	69,0	21,0	32,0	16	44	136,5	32	223,00	5
908201	HELU-S-PAB-AL/CU-DIN 300	300	-	69,0	23,3	34,0	18	46	138,0	34	272,40	5
908202	HELU-S-PAB-AL/CU-DIN 400	400	-	70,0	26,0	38,5	20	52	150,0	38	379,00	5
908203	HELU-S-PAB-AL/CU-DIN 500	500	-	80,0	29,0	44,0	22	58	176,0	44	575,20	5

# WK-SC-P Shear Bolt Connector

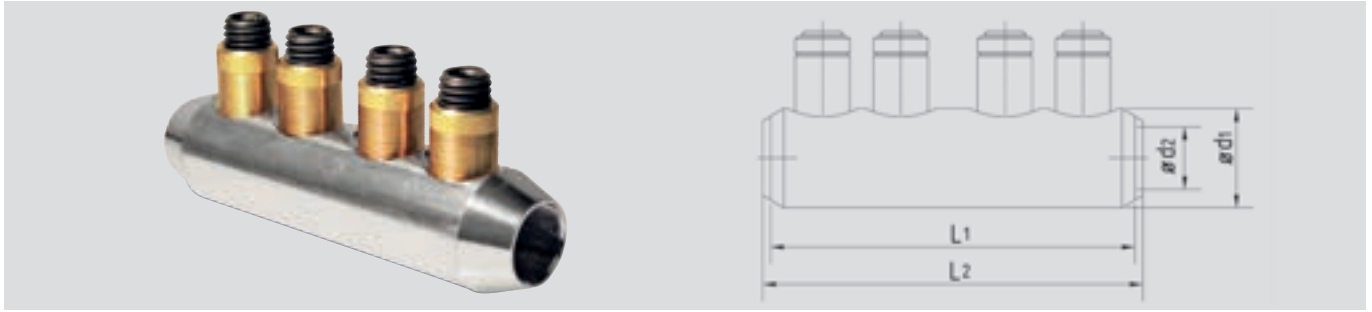

## Technical Data

**Material:** Aluminium alloy  
**Surface:** tin plated  
**Dimensions:**  $d_1 = 42 \text{ mm}$   
 $d_2 = 26.2 \text{ mm}$   
 $L_1 = 220 \text{ mm}$

## Design

- with divider
- Conductor channel with transverse grooves and protection against conductor oxidation

**These bolt connectors were developed especially for the HELUWIND® WK POWERLINE ALU and successfully tested according to IEC– DIN EN 61238-1 Class A.**

SICON bolt connector

185-400 + 500 mm<sup>2</sup> RE Al/Cu + 300 flex

**Thanks to the special design of the bolts, there are no pre-determined breaking points in the threads. Instead the bolt always reliably rips on the surface of the terminal body.**

- **No protrusions on the terminal body**
- **Full utilization of the thread load carrying capacity for every conductor cross section**
- **No special tool required**
- **Gentle shearing off of the shear bolt makes tightening easier**

fine-wire	185 - 240 (300 max. Ø 26 mm)	185 - 240 (300 max. Ø 26 mm)
SM 120°	185 (240 pressed round)	185 (240 pressed round)
SE 120°	185 - 240	
SM 90°	185 - 240	185 - 240
SE 90°	185 - 240	
RE	185 - 500	185 - 500
RMV	185 - 400	185 - 400
RM	185 - 400	185 - 400
Conductor types as per DIN 60228 - 09/2005		Cross section range: copper conductor
		Cross section range: aluminium conductor

Other conductor cross sections and dimensions on request.

## SICON – The first stepless shear bolt

- 1 A standard hexagonal wrench works on a threaded pin which will be screwed into the hole of the stepless compression bolt. The traction is not interrupted by any step or notch on the bolt.
- 2 When screwing in the SICON bolt, the pressure plate loosens on the bottom of the bolt. The bolt now turns on this plate; compared to conventional bolts, no head friction occurs on the conductor. The bolt's torque generates the contact pressure almost independently of the conductor material. This way, a significantly higher contact pressure is achieved for Aluminium conductors and even fine-wired conductors are not damaged.
- 3 The SICON bolt continues to turn until the shearing moment is reached. When screwed in, the thrust bolt is tensioned; on reaching the shearing moment, it stretches axially and tears. Compared with conventional shear bolts, the bolt breaks very smoothly.
- 4 The SICON bolt always shears directly on the surface of the terminal body. This ensures that the protrusion is always minimized, irrespective of the conductor to be connected.

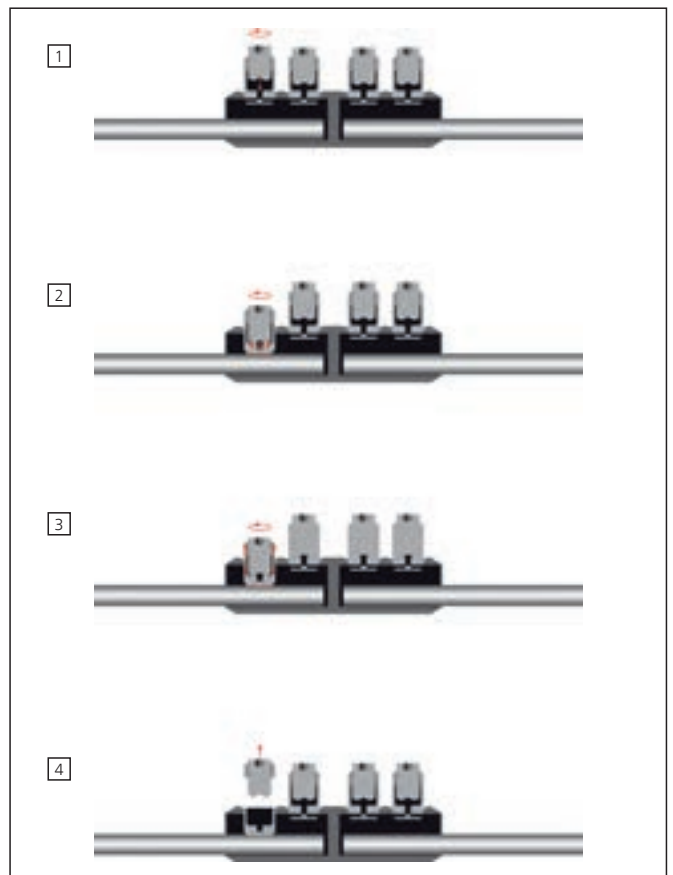

Dimensions and specifications may be changed without prior notice.

# WK-SC-T Shear Bolt Connector



## Bolt connector with shear bolts for HELUWIND® WK POWERLINE ALU fine-wire aluminium conductors.

A connection technology with dual shear bolts, especially developed for the WK POWERLINE ALU series. This newly-developed bolt technology differs from conventional techniques as the aluminium conductor is contacted in a 2-step-procedure. First of all, the dual bolt technology fastens the fine-wire aluminium conductor. As a second step a mandrel is inserted into the conductor, what completes the conductor's crucial sealing and contacting.

### Properties

- Easy and secure connection system for flexible Cl. 5 aluminium cables tested according to IEC-61238-1 Class A.
- New patented two-step shear off bolts provide predetermined torque & ensure reliable and secure contact without damaging fine aluminium strands.
- Easier and faster installation - no tools required.
- Available for cable cross sections 70 mm<sup>2</sup> through 500 mm<sup>2</sup>.
- Dual connection technology available for connecting the HELUWIND® WK POWERLINE ALU series.

#### Optional: Reduction Connector

HELUWIND® WK POWERLINE ALU series to Cl. 2 aluminium

HELUWIND® WK POWERLINE ALU series to Cl. 5 aluminium

Part no. and prices on request.

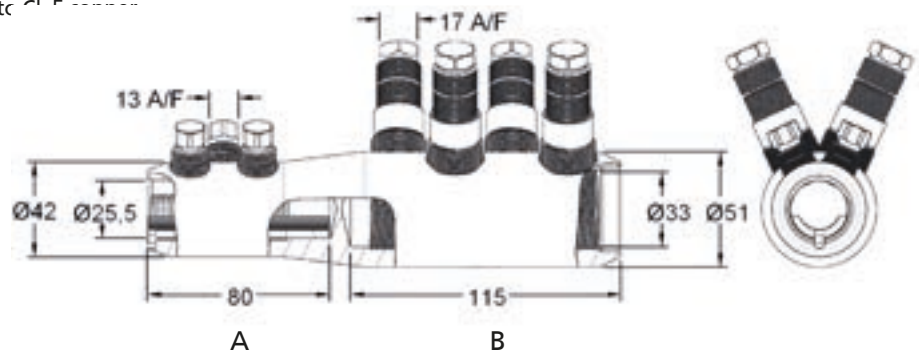

Diameter range table		AL					CU		
A	mm <sup>2</sup>	150/400	150/400	150/240	185/300 (300 with 90°)		150 / 400	150/185	300 (Class 5)
	Ø mm	13,7 / 24,6	12,9 / 22,2				13,7 / 24,6		23,5 / 25
B	mm <sup>2</sup>					400 (Class 5)			
	Ø mm					27 / 29			

Dimensions and specifications may be changed without prior notice.



# WK-SL-T Shear Bolt Cable Lug



## **Bolt cable lug with shear bolts for HELUWIND® WK POWERLINE ALU fine-wire aluminium conductors.**

A connection technology with dual shear bolts, especially developed for the HELUWIND® WK POWERLINE ALU series. This newly-developed bolt technology differs from conventional techniques as the aluminium conductor is contacted in a 2-step-procedure. First of all, the dual bolt technology fastens the fine-wire aluminium conductor. As a second step, a mandrel is inserted into the conductor, what completes the conductor's crucial sealing and contacting.

## **Properties**

- Easy and secure connection system for Cl. 5, flexible aluminium conductors, tested according to IEC-61238-1 Cl. A.
- Patented two-step, shear off bolts provide predetermined torque & ensure reliable and secure contact without damaging fine aluminium strands.
- Easier and faster installation - no tools required.
- Available for cross sections: 70 mm<sup>2</sup> - 500 mm<sup>2</sup>.
- Dual shear bolt cable lugs are designed for connecting the HELUWIND® WK POWERLINE ALU series.

Part no. and prices on request.

Dimensions and specifications may be changed without prior notice.

# Bolt Cable Lug with Shear Head

For copper Cl. 5 and aluminium Cl. 2



## Bolt Cable Lug with Shear Head

### Properties

- Available for cross sections 120 mm<sup>2</sup> through 400 mm<sup>2</sup>
- Tested according to IEC 61238-1 Cl. A
- Up to U<sub>0</sub> /U (U<sub>m</sub>) 18/30 (36) kV
- Connector: High-strength aluminium alloy
- Threaded screws: aluminium alloy with multiple shear heads
- Surface: tin-plated for aluminium and copper conductors

### Advantages

- Designed with insulation throughout the entire length
- Suitable for indoor and outdoor applications
- Particularly-long sealing length to protect against moisture

Not for fine-wire aluminium stranding.

Part no. and prices on request.

# Bolt Connector with Shear Head

For copper Cl. 5 and aluminium Cl. 2



## Bolt Connector with Shear Head

### Properties

- Available for cross sections 10 mm<sup>2</sup> through 1000 mm<sup>2</sup>
- Tested according to IEC 61238-1 Cl. A
- Up to  $U_0/U (U_m)$  18/30 (36) kV
- Connector: High-strength aluminium alloy
- Threaded screws: aluminium alloy with multiple shear heads
- Surface: tin-plated for aluminium and copper conductors

### Advantages

- Greater connection area
- Conductor connection canal with longitudinal and lateral grooves, which allows for good electrical contacts and tearing up the oxide coating on the conductors

Not for fine-wire aluminium stranding.

Part no. and prices on request.

Dimensions and specifications may be changed without prior notice.

# Mechanical Split Connector with Shear Head

For copper Cl. 5 and aluminium Cl. 2



## Mechanical Split Connector with Shear Head

### Properties

- Available for cross sections 120 mm<sup>2</sup> through 400 mm<sup>2</sup>
- Tested according to IEC 61238-1 Cl. A
- Connector: High-strength aluminium alloy
- Threaded screws: aluminium alloy with multiple shear heads
- Surface: tin-plated for aluminium and copper conductors

### Advantages

- Greater connection area
- Conductor connection canal with longitudinal and lateral grooves, which allows for good electrical contacts and tearing up the oxide coating on the conductors

Not for fine-wire aluminium stranding.

Part no. and prices on request.

Dimensions and specifications may be changed without prior notice.

# HYDAC - Fastening systems in the turret

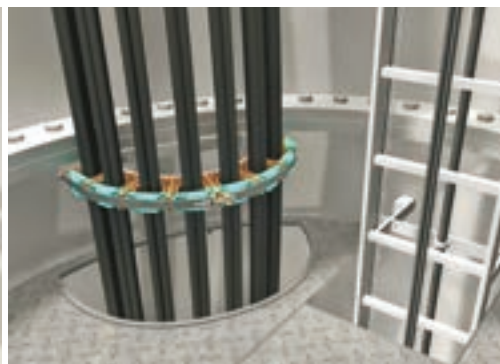
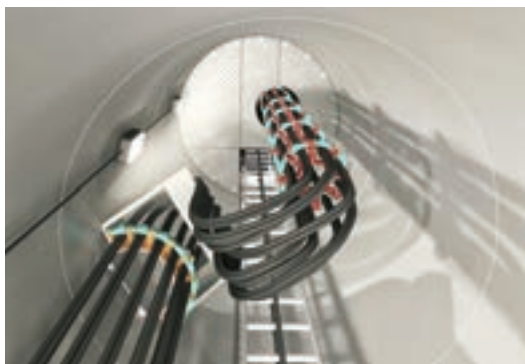

TURRET – “half-moon”  
HRFLEX 3x to 9x (AC)



Requirements from the customer for the new cable fastening:

- Modular construction system
- Compact design
- Turret: Simple assembly of the fastening system
- Cable: Fast and simple type of fastening
- Good accessibility to all cables
- Simple to replace the cable
- Compensation of the cable tolerances up to 10%
- Short-circuit proof up to 20 kA
- Fire resistant material
- Temperature independent and reliable retention force of the cable
- No damage of the cable insulation (e.g., pinching)

Advantages:

- Flexible for power cable up to 10% Ø difference
- Cable diameter up to 35mm
- Fast and maintenance friendly assembly in the horizontal and vertical turret.
- For 1-3 power cables through inserts
- Fire resistant acc. to UL94-class V0
- Designed for short-circuit current up to 20 kA
- Better protection of insulation of the power cable
- Suitable for temperatures from -40°C (survival) bis +90°C
- Fast replacability of the individual cables
- Constant pressure force through spring assemblies

TURRET – “star” spacer

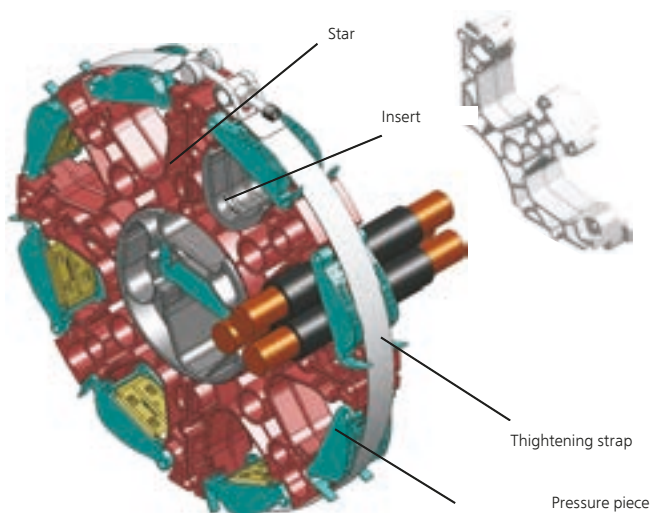

Test and inspections performed:

- Short-circuit test up to 41 kA  
(Short-circuit test with ASTA certificate existing)
- Cold test under load -40°C, 20h
- Hot test +90°C (copper core) under load
- Material acc. to UL94 – V0 (fire resistant)
- Load test > 30 days, outside of the premises
- Tensile test of the trigger
- Loading and bending test of the base frame
- Loop test
- Lifetime and aging test of the material
- Salt and spray test

Outstanding tests and certificates:

- GL - certificate

# Cable clamps



## Cable clamps K

For fastening single-wire and multiple-wire cables.

### With additional elastic insert:

- 1) For padding the cable (over an outside diameter of  $\geq 60$  mm), to avoid damage during loading, or change of the ambient temperature.
- 2) In the area of riser lines of a desired height to accept the weight forces and secure fixation of the cables.
- 3) Fastening of cables with smaller outside diameter to expand the clamping range of the clamp.

### Technical Data

Material:	Polyamide, glass fiber reinforced
Diameter range:	18 to 90 mm
Mechanical short-circuit protection:	10000 N
Max. tightening torque of the fastening screws:	5 Nm

## Cable clamps KS

For fastening single-wire cable in diagonal bracing.

### With additional elastic insert:

- 1) In the area of riser lines of a desired height to accept the weight forces and secure fixation of the cables.
- 2) Expansion of the clamping range of the clamp to fasten cables with smaller outside diameter.
- 3) The hole for a M10 bolt in the lower part of the cable clamps enables a direct fastening, e.g., on floors, walls, lattice, concrete or wood masts.

### Technical Data

Material:	Polyamide, glass fiber reinforced
Diameter range:	22 to 46 mm
Mechanical short-circuit protection:	12500 N
Max. tightening torque of the fastening screws:	5 Nm

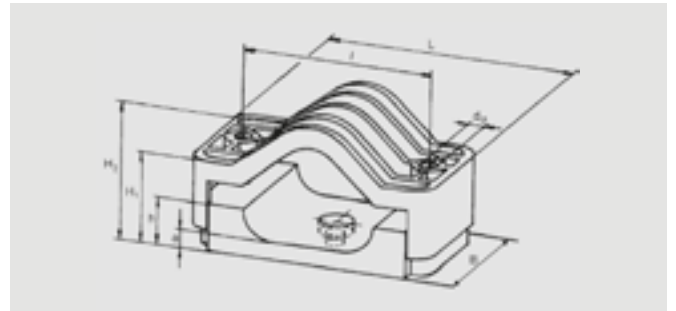
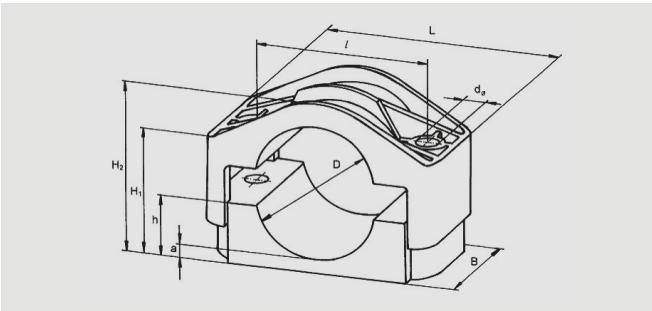

### Cable clamps K

Type	D mm	Diameter with an elastic insert in mm	Diameter with an elastic insert in mm	L in mm	B in mm	l in mm	d in mm	H1 in mm	H2 in mm	h in mm	a in mm
K26/38	24-38	21-35	18-32	91	60	60	12	36-47	46-57	19	7
K36/52	36-52	32-49	29-46	108	60	75	12	43-56	56-72	24	8
K50/75	50-75	47-72	44-69	126	60	95	12	51-77	74-98	30	9
K66/90	66-90	63-87	60-84	158	70	120	14	65-89	91-115	42	10

### Cable clamps KS

Type	D mm	Diameter with an elastic insert in mm	L in mm	B in mm	l in mm	d in mm	H1 in mm	H2 in mm	h in mm	a in mm
KS 25/36	25-36	22-33	150	80	110	12	55-75	77-97	35	15
KS 33/46	33-46	30-43	170	80	130	12	55-85	95-115	35	19

# HELWIND® WK-Multiclamp

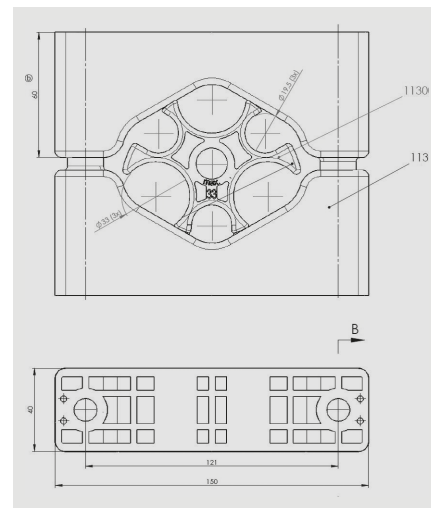

## Requirements of the customer for the new cable fastening

- Modular construction: For single or surface mounting (with several layers)
- Clamp bodies and inner adapter made of flame-retardant plastic PPV0: Test and V0 classification corresponding to UL 94 (Vertical Burning Test)
- Fastening accessories (as for example, threaded pins, nuts, cover plates and any kind of sub-construction) made of steel or stainless steel – selection of suitable fastenings based on various test routines – dependent on application surroundings (e.g., dimensions, weight, and insulation of the used cables).

## Material PPV0

To further improve the preventative fire protection, wind energy clamps are made out of the flame-retardant plastic PPV0. These were tested corresponding to UL 94 (Vertical Burning Test) and classified in the category V0.

UL 94 is a test method of the Underwriters Laboratories for inter-branch evaluation and classification of the flammability of plastics:

A test specimen is fastened in the vertical position and subjected to a flame for a duration of 10 seconds from the bottom out over an open ignition source.

A second flame treatment was introduced for a duration of 10 seconds directly after extinguishing the test specimen.

V0 then the highest level and classified as the most flame resistant materials: Extinguish clamped test specimen within 10 seconds without burning drops of melted plastic.



## Special clamps

Individually fabricated fastening solutions for pipes, cables and other parts:

- Fabricated according to customer specifications or on the basis of own developments
- As machined or die cast version, depending on material, dimensions and quantity
- Fabrication of various plastics (PP oder PA), thermoplastics, elastomer or non-ferrous metals
- Flame-retardant materials according to various international fire protection standards



# The Roxtec Sealing Solution

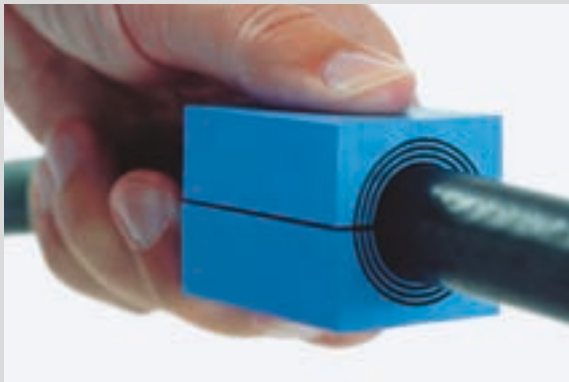
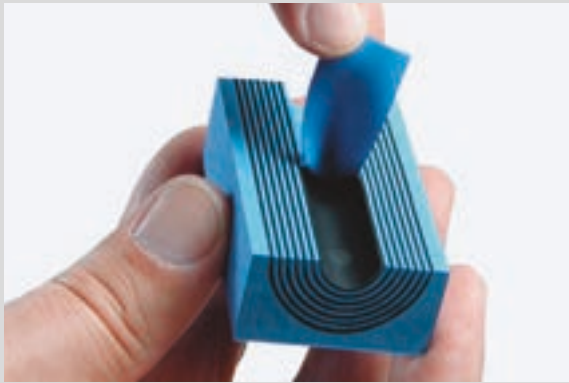

The Roxtec module partitions secure cable and pipe installations in demanding applications in wind-turbine engineering.

Special products for the housing insert and control-cabinet construction sectors are available.

## The solution:

Multidiameter™ – the flexible, adaptable Roxtec delayering technology provides thousands of constructors, fitters and operators secure and sophisticated lead-throughs for cables and pipes.

With our wide spectrum of frames and inserts you will achieve perfect sealing in every outer diameter. Even subsequent expansions to finished installations become problem-free.



## Multidiameter™ Module kits for frame size 6



RM Kit 601



RM Kit 602

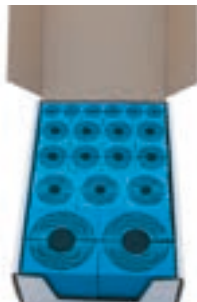

RM Kit 603

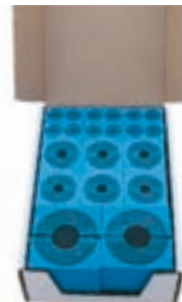

RM Kit 604

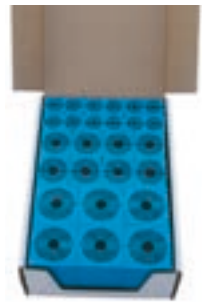

RM Kit 605



# The Roxtec Sealing Solution

## Example of use

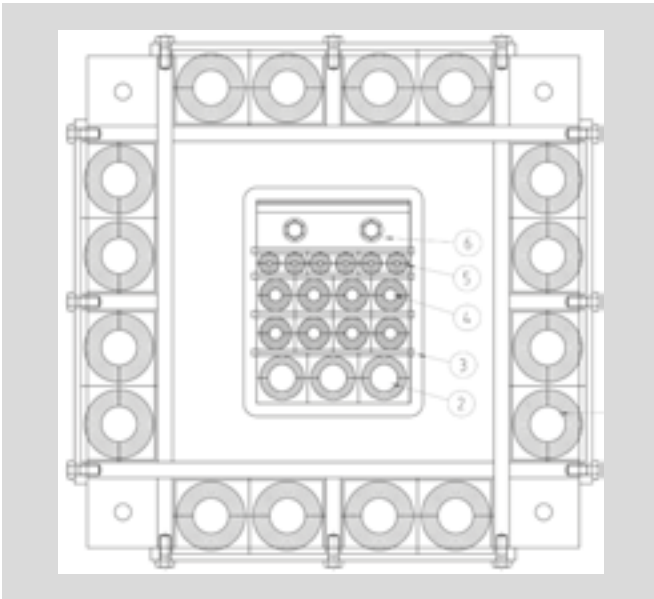
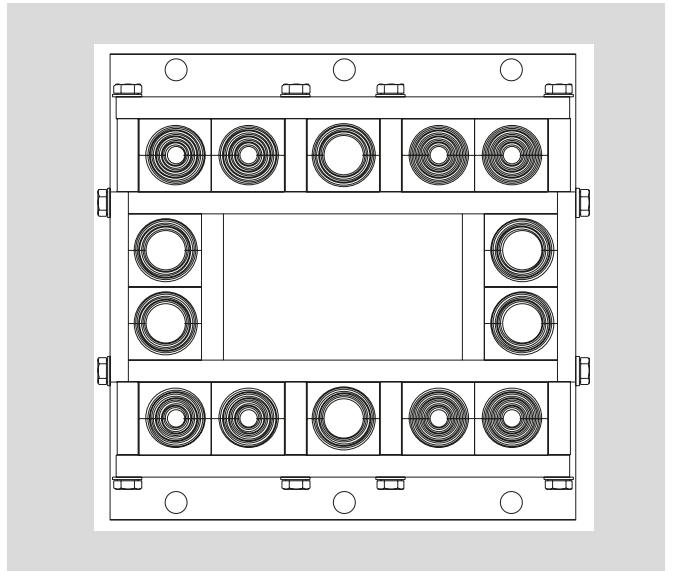

This layout facilitates separating power cables from signal and OWG connections

Separating the power cable in the cable retainers positively influences any arising stagnation temperatures

## Multidiameter™ Modules with core

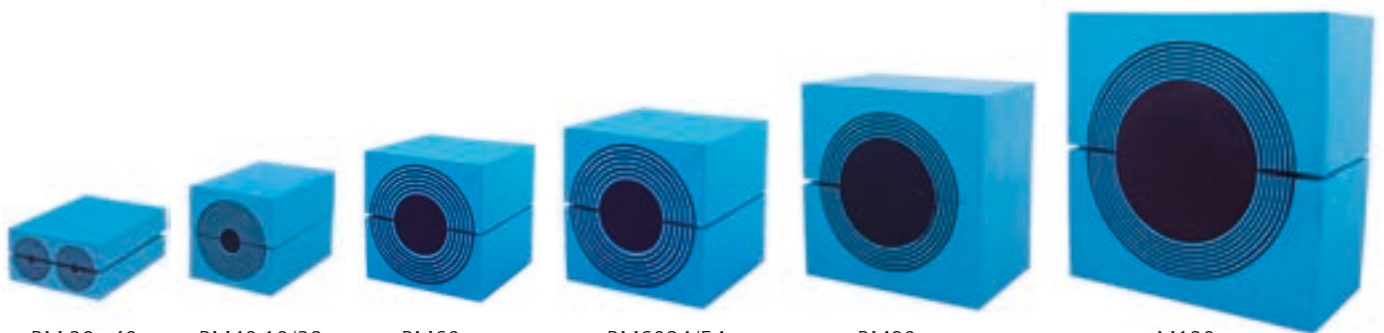

RM 20w40

RM40 10/32

RM60

RM6024/54

RM90

M120

# Cable Fittings from Tyco Electronics Raychem GmbH

## Cable connection RSTI

Screened, separable connection system RSTI, 630A up to 36kV, cross section: 25mm<sup>2</sup> - 630mm<sup>2</sup> for SF6-insulated switchgear with 630A bushings, Type C, 630/1250A according to CENELEC HD506 S1, EN 50180 and EN 50181



## Coupling plug RSTI-CC

Screened, separable coupling connection system RSTI-CC, 630A up to 36kV, cross section: 25mm<sup>2</sup> - 630mm<sup>2</sup> in combination with connection system RSTI for SF6-insulated switchgear with 630A bushings, Type C, 630/1250A according to CENELEC HD506 S1, EN 50180 and EN 50181



Typical application in a switching system.

Dimensions and specifications may be changed without prior notice.

# Cable Fittings from Tyco Electronics Raychem GmbH

## Medium-voltage

### MXSU Heat-shrink joint

Heat-shrink joint MXSU for polymeric insulated cables up to 36kV, cross section: 25mm<sup>2</sup> - 500mm<sup>2</sup> incl. mechanical connectors



### SXSU Heat-shrink joint

Heat-shrink joint SXSU for polymeric insulated cables up to 36kV, cross section: 25mm<sup>2</sup> - 1200mm<sup>2</sup> for compression joints



## Low-voltage

### UAGA Heat-shrink joint

Heat-shrink joint UAGA for polymeric insulated cables up to 1kV, cross section: 1.5mm<sup>2</sup> - 300mm<sup>2</sup>



### VMDU Heat-shrink joint

Heat-shrink joint VMDU for control cables, cross section: 4 - 75 x 1.5mm<sup>2</sup> - 2,5mm<sup>2</sup>



# IREV-S indoor termination, shrinking type



## IREV-S

The interior end seals are suitable for all single-conductor and three-conductor. Medium-range voltage plastic cables with differing conductor layers and sheath designs up to 18/30(36)kV.

## Properties

- safe field effect
- simple assembly
- wider application range
- excellent external layer behaviour
- unlimited conductivity
- immediately operational

## Scope of delivery

- Packing unit: 1
- suspensible silicon control element
- sealing band
- creeping current resistant, weather-proof heat shrink-on tube
- assembly instruction
- suspensible silicone sheds

## Note

- An additional earthing kit is required for cables with copper sheath.
- Without terminals.
- 1 unit = 1 set with 3 items.

## single core

Part no.	Type	Nominal voltage U <sub>0</sub> /U(U <sub>m</sub> )	Cross-section mm <sup>2</sup>	Unit	
93190	IREV-S12/1	6/10kV	10,0 - 25,0	1	-
93191	IREV-S12/1	6/10kV	25,0 - 95,0	1	-
94420	IREV-S12/1	6/10kV	95,0 - 240,0	1	-
93192	IREV-S12/1	6/10kV	150,0 - 400,0	1	-
93193	IREV-S12/1	6/10kV	240,0 - 500,0	1	-
94421	IREV-S12/1	6/10kV	400,0 - 800,0	1	-
94422	IREV-S12/1	6/10kV	800,0 - 1000,0	1	-
94423	IREV-S24/1	12/20kV	10,0 - 35,0	1	-
93194	IREV-S24/1	12/20kV	25,0 - 150,0	1	-
93195	IREV-S24/1	12/20kV	70,0 - 240,0	1	-
93196	IREV-S24/1	12/20kV	120,0 - 300,0	1	-
93197	IREV-S24/1	12/20kV	240,0 - 500,0	1	-
94424	IREV-S24/1	12/20kV	630,0 - 1000,0	1	-
93198	IREV-S36/1	18/30kV	35,0 - 70,0	1	-
94425	IREV-S36/1	18/30kV	50,0 - 150,0	1	-
93199	IREV-S36/1	18/30kV	150,0 - 400,0	1	-
93200	IREV-S36/1	18/30kV	500,0 - 800,0	1	-

Dimensions and specifications may be changed without prior notice.

# FLEV-S outdoor termination, shrinking type



## FLEV-S

The outside end seals are suitable for all single-conductor and three-conductor medium-range voltage plastic cables with differing conductor layers and sheath designs up to 18/30(36)kV.

## Properties

- Safe field effect
- Simple assembly
- Wider application range
- Excellent external layer behaviour
- Unlimited conductivity
- Immediately operational

## Scope of delivery

- Packing unit: 1
- suspensible silicon control element
- sealing band
- creeping current resistant, weather-proof heat shrink-on tube
- assembly instruction
- suspensible silicone sheds

## Note

- An additional earthing kit is required for cables with copper sheath.
- Without terminals.
- 1 unit = 1 set with 3 items.

## single core

Part no.	Type	Nominal voltage U <sub>0</sub> /U(U <sub>m</sub> )	Cross-section mm <sup>2</sup>	Unit	
93360	FLEV-S12/1	6/10kV	10,0 - 25,0	1	-
93361	FLEV-S12/1	6/10kV	25,0 - 95,0	1	-
94426	FLEV-S12/1	6/10kV	95,0 - 240,0	1	-
93362	FLEV-S12/1	6/10kV	150,0 - 400,0	1	-
93363	FLEV-S12/1	6/10kV	240,0 - 500,0	1	-
94427	FLEV-S12/1	6/10kV	400,0 - 800,0	1	-
94428	FLEV-S12/1	6/10kV	800,0 - 1000,0	1	-
94429	FLEV-S24/1	12/20kV	10,0 - 35,0	1	-
93364	FLEV-S24/1	12/20kV	25,0 - 150,0	1	-
93365	FLEV-S24/1	12/20kV	70,0 - 240,0	1	-
93366	FLEV-S24/1	12/20kV	120,0 - 300,0	1	-
93380	FLEV-S24/1	12/20kV	240,0 - 500,0	1	-
94430	FLEV-S24/1	12/20kV	630,0 - 1000,0	1	-
93367	FLEV-S36/1	18/30kV	35,0 - 70,0	1	-
93368	FLEV-S36/1	18/30kV	50,0 - 150,0	1	-
93369	FLEV-S36/1	18/30kV	150,0 - 400,0	1	-
93370	FLEV-S36/1	18/30kV	500,0 - 800,0	1	-

Dimensions and specifications may be changed without prior notice.

# Repair Sleeves for shielded single-conductor plastic cable

with bolt connector -  $U_0/U_m$  6/10 (12) kV to 12/20 (24) kV

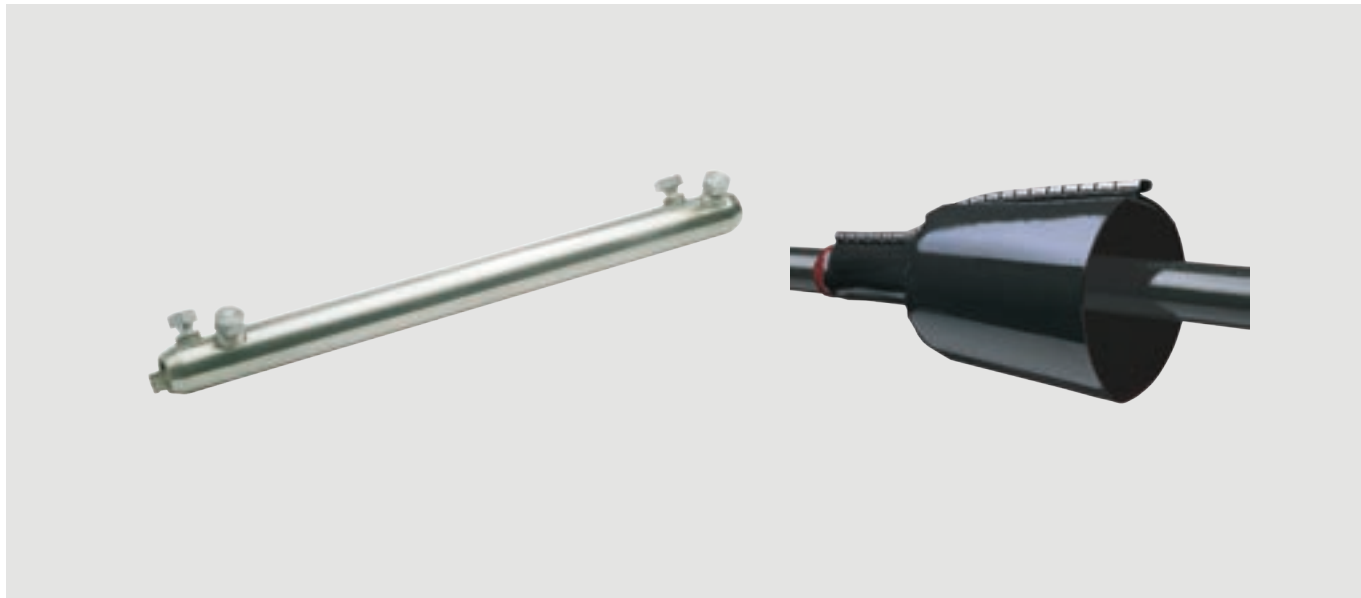

## Sleeve

• Sleeve designed for 12 kV and 24kV plastic-insulated cables:

The main design of these sleeves matches the hereafter mentioned MXSU connection sleeves, in which the feeder terminal hose and the sleeve body are roughly twice as long. From prior experience a part of the cable or sleeve will need to be cut out when the cables are damaged, a longer repair bolt connector and a fibre-reinforced cuff are used to restore the conductor connection, which significantly reduces space requirements for the sleeve hole, since the outer hose's stop position is no longer necessary. This allows for bridging gaps up to 320 mm.

## Pressure-resistant sleeve

• Pressure-resistant repair sleeves 24 kV:

This sleeve is a special product that was developed during the "Cable Cure" cable refurbishing process. The design matches the repair sleeve for plastic cables. The sleeve's required compressive strength is achieved by additional, pressure-resistant cuffs over the sleeve body. A bolt connector with the appropriate length allows for smooth replacement of the missing conductor piece after disassembling the existing connection sleeves. This application is available upon request.

## Cable

• The sleeves described here are used for repairing cable errors and/or defective sleeves up to 320 mm long on plastic-insulated cables of up to 24 kV. This application is available for the following cables: N(A)YSY, N(A)2YSY, N(A)2XS(FL)2Y, N(A)2YHCaY, N(A)2XS(FL)Y. Additional cable types available upon request.

## Note

• For cross sections from 25mm<sup>2</sup> to 500mm<sup>2</sup>

Part no. and prices on request.

# Medium-Voltage Cable Accessories

## INLINE Junction Box up to 42 kV

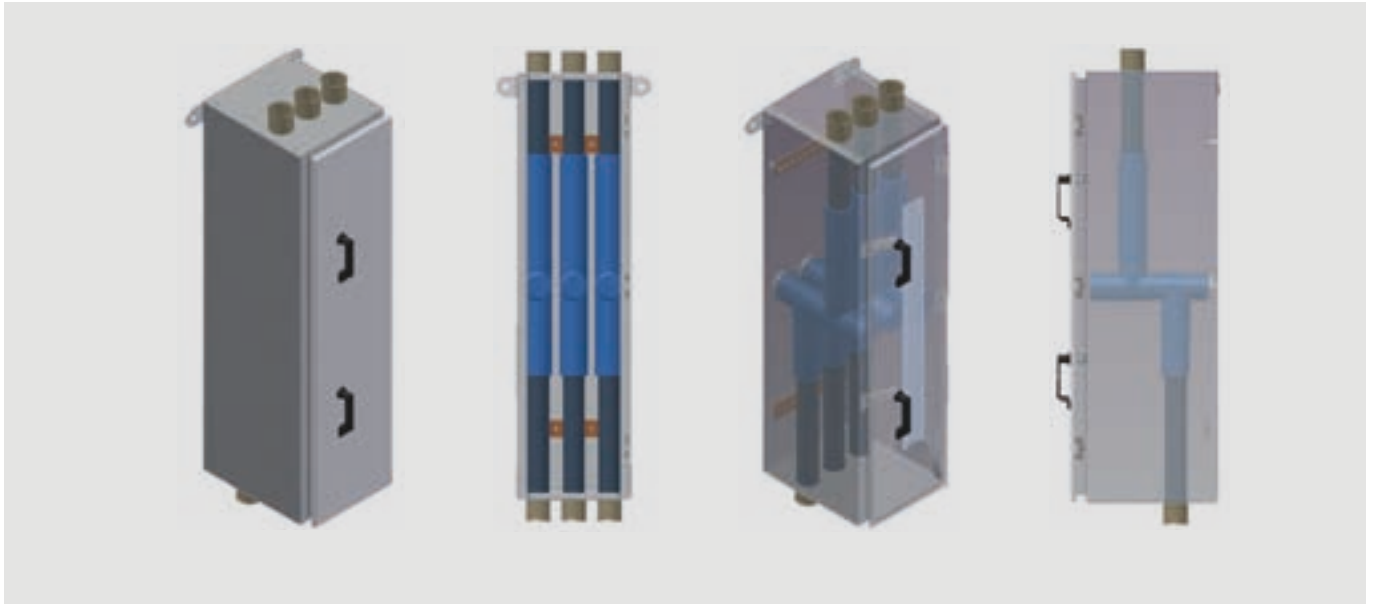

### Medium-voltage distributor connector for three insulated cable connectors, up to a max. of 42KV

The MS distributor connector saves a lot of space, thanks to the inline array of the insulated medium-voltage cable connectors, and is easy to install.

- Conductor cross section 25mm<sup>2</sup> to 300mm<sup>2</sup>
- Connection for many conductor materials, copper or aluminium cables
- Voltage level up to 42 kV
- Powder-coated metal housing
- On request: corrosion resistant high-grade steel for offshore uses
- Height: 1200mm/Depth: 400mm/Width: 320mm
- For medium-voltage cable connection set type RST1

Part no. and prices on request.

Dimensions and specifications may be changed without prior notice.

# SK-D heat shrink 3:1 - with interior adhesive

polyolefine - thick walled

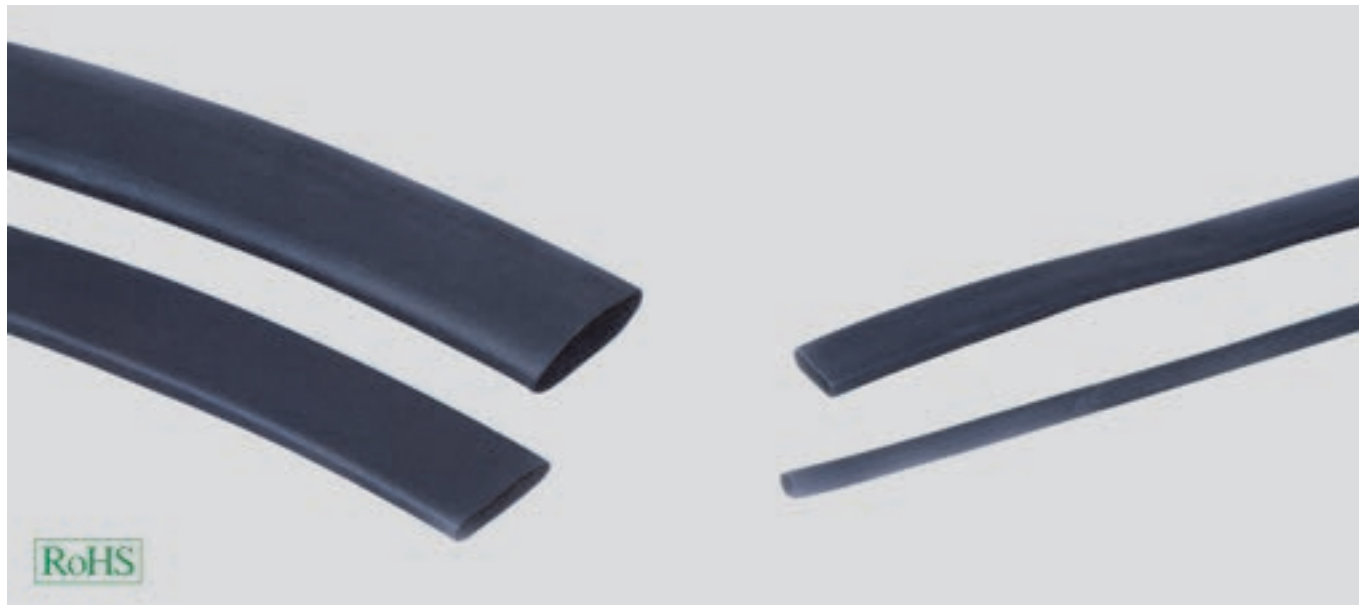

## SK-D

Polyolefine shrunk tube with internal adhesive for repairing insulation and sealing electrical components.

For the protection of cable sleeves and terminations for low-voltage applications (600V).

Good protection against impact and abrasion.

## Application

- Plant and machine construction
- Robot construction
- Automation technology
- Vehicle construction and shipbuilding
- Installation technology
- Control cabinet construction

## Material

PO (Polyolefine) with internal adhesive

Colour: black

- halogen-free

## Note

Form of shipment:

1.2 m rods

Approval:

UR-listed up to size 68,1mm

## Technical data

Temperature range: -55°C up to +110°C

## black

Part no.	Inner Ø before shrinkage mm	Wall thickness mm	Inner Ø after shrinkage mm	Content m	Unit
905344	8,9	1,8	3,0	rods of 1,22m	1
905335	13,0	2,4	4,1	rods of 1,22m	1
905336	19,1	2,4	6,1	rods of 1,22m	1
905337	27,9	3,0	8,9	rods of 1,22m	1
905338	38,1	4,1	11,9	rods of 1,22m	1
905339	50,8	4,1	16,0	rods of 1,22m	1
905340	68,1	4,1	22,1	rods of 1,22m	1
905731	89,9	4,1	30,0	rods of 1,22m	1
905732	119,9	2,0	39,9	rods of 1,22m	1

Dimensions and specifications may be changed without prior notice.



# Rollover Insulation Hose

For fixed connection of a 0.6/1kV single-conductor cable



## Field of application

- Good versatility; for connecting and sealing single-conductor and coax cables
- Indoors, outdoors, soil, water, installation channels and pipes
- Ideal for locations without flames

## Approval

- UL/CSA ANSI

## Properties

- The hoses consist of a double-walled endless EPDM pipe filled with lubricant, which is easily rolled over the cable and connector.
- Large field of application, with only 4 types, the full low-voltage range is covered.
- UV-resistant and halogen-free
- Resistant against environmental and chemical influences such as alkalis in the soil.
- Suitable for press connectors (not included)

## Advantages

- Reliable protection against moisture and water
- Quick and easy installation without tools
- Can be installed at up to -25°C without significant effort
- Voltage is immediately switched on after successful installation
- Continuous operation temperature range -40°C to +130°C
- Can be stored indefinitely

Part no. and prices on request.

# WK-APW 18 Battery-operated compression tool



## WK-APW 18 Battery-powered compression tool

- Special tool for crimping cable lugs and connectors up to 1000mm<sup>2</sup>
- 3 years warranty or 20,000 cycles
- Fast feed in low pressure, with dual-piston hydraulic
- Variable speed for positioning the tool
- Ergonomic design for effortless work
- Service friendly, compact design
- Two-component handle with optimum weight distribution
- Integrated LED for illuminating the working area
- Pressing force: 130 kN
- Max. stroke: 42 mm
- Head opening: 42 mm
- Dimensions: W 95mm x L 430mm x H 310mm
- Weight: approx. 8,7 kg
- Rechargeable battery: Li-Ionen; 18V; 3Ah

Part no.	Type	Unit
909871	WK-APW 18	1

Dimensions and specifications may be changed without prior notice.

### C8-Crimping dies for HELUWIND® WK POWERLINE ALU

Part No.	Cross Section
907014	95 mm <sup>2</sup> + adapter 906411
906434	150 mm <sup>2</sup>
907200	185 mm <sup>2</sup>
906446	240 mm <sup>2</sup>
906206	300 mm <sup>2</sup>
906766	400 mm <sup>2</sup>

Please order crimping dies separately!

# WK-Electro hydraulic pump with battery



## WK-electro-hydraulic, battery-operated pump

- Light, compact and robust structure
- Double piston technology for rapid, high-pressure feed
- Quick tool return by high return conveyor volume
- Pressure monitoring with an electronic pressure sensor
- High-performance battery (lithium-ion) with charge level indicator
- Remote control, 1.5 m
- Power button located on the device and on the remote control
- Remote controlled hydraulic cylinder
- Control by means of microcontroller
- LED-display (green) for correct processing on the device and remote control
- LED-display for battery and processing errors on the device
- Automatic energy save mode after 5 min. in idle
- Crimp and error message history on internal memory (app. 100000 cycles)
- Read out of all cycles and error messages from USB
- Permanent supervision of remaining battery load prevents uncompleted crimping cycles
- Controlled engine drive for long life of gear, engine and battery
- Automatic and manual retract, retract stop function
- Increased cutting frequency by means of automatic cutting detection (pat. pending)
- Integrated service-management
- Software update from USB connection
- Temperature monitor
- Pump can be carried using shoulder strap, carry bag with additional pockets
- Remote control can be fastened to the pump, belt or shoulder strap

## Note

Pressing cylinder and crimping head are **not** part of the product. Please order C8 Pressing cylinder and crimping head separately.

## Scope of delivery

- Battery-operated pump
- Remote control, 1,5m
- Flexible hose, 1,5m
- USB cable
- Li-Ion battery, 18V, 3,0Ah
- Battery charger
- Software (CD)
- Shoulder strap
- Carry bag with additional pockets

Part no.	Type	Unit
906207	WK-Electro hydraulic pump with battery	1

Dimensions and specifications may be changed without prior notice.

# WK-Electro-hydraulic radial-piston-pump (230) with transport cart



## WK-Electro-hydraulic radial-piston-pump (230V) with transport cart

- Electrical controls
- Pressure control valve
- Magnet valve
- Oil sight glass
- 3 meter high-pressure hose
- Pump controlled with a foot pedal which is equipped with a high-quality, 3-point safety switch
- Operating pressure: max. 700 bar
- Operating voltage: 230V, 50Hz
- Delivery rate: 0,64l/min
- Nominal capacity: 0,75 kW
- Foot pedal with one switch
- Weight: 32,5 kg

## Note

Without cutting and crimping tool  
Optional: 400V version available

## Scope of delivery

- Battery-operated hydraulic compression tool
- Battery
- Charger
- Transport cart

Part no.	Type	Unit
906721	-	1

Dimensions and specifications may be changed without prior notice.

# HELUTOOL HAP 60-2 Battery-powered hydraulic tool in toolbox



## HELUTOOL HAP 60-2 Battery hydraulic tool in toolbox

- For processing Cable lugs and Connectors up to 300mm<sup>2</sup>
- Quick infeed due to doublee piston hydraulic system
- Variable speed fir placing the tool
- Ergonomic design for fatigue-free work
- Easy to service and compact design
- Two-piece component handles with optimal weight distribution
- Powerful Li-Ion battery 18 V
- LED to illumination of the workspace
- Crimping area: 6-300 mm<sup>2</sup>
- Pressing forces: ca. 60 kN
- Head rotation: 360°
- Opening range: 17 mm
- Battery voltage: 18 V
- Weight incl. battery: approx. 4,4 kg
- Tool dimensions: 330 x 331 x 75 mm

## Note

Exclusive inserts

Matching inserts:  
HELU-S-PE-SK und HELU-S-PE-WM  
Further inserts on request

## Scope of delivery

- Battery-powered hydraulic tool
- Battery
- Battery charger
- Carry strap
- Manual
- Transport case

Part no.	Type	Unit
908494	HAP 60-2	1

Dimensions and specifications may be changed without prior notice.

**По вопросам продаж и поддержки обращайтесь:**

Алматы (7273)495-231	Казань (843)206-01-48	Новокузнецк (3843)20-46-81	Смоленск (4812)29-41-54
Архангельск (8182)63-90-72	Калининград (4012)72-03-81	Новосибирск (383)227-86-73	Сочи (862)225-72-31
Астрахань (8512)99-46-04	Калуга (4842)92-23-67	Омск (3812)21-46-40	Ставрополь (8652)20-65-13
Барнаул (3852)73-04-60	Кемерово (3842)65-04-62	Орел (4862)44-53-42	Сургут (3462)77-98-35
Белгород (4722)40-23-64	Киров (8332)68-02-04	Оренбург (3532)37-68-04	Тверь (4822)63-31-35
Брянск (4832)59-03-52	Краснодар (861)203-40-90	Пенза (8412)22-31-16	Томск (3822)98-41-53
Владивосток (423)249-28-31	Красноярск (391)204-63-61	Пермь (342)205-81-47	Тула (4872)74-02-29
Волгоград (844)278-03-48	Курск (4712)77-13-04	Ростов-на-Дону (863)308-18-15	Тюмень (3452)66-21-18
Вологда (8172)26-41-59	Липецк (4742)52-20-81	Рязань (4912)46-61-64	Ульяновск (8422)24-23-59
Воронеж (473)204-51-73	Магнитогорск (3519)55-03-13	Самара (846)206-03-16	Уфа (347)229-48-12
Екатеринбург (343)384-55-89	Москва (495)268-04-70	Санкт-Петербург (812)309-46-40	Хабаровск (4212)92-98-04
Иваново (4932)77-34-06	Мурманск (8152)59-64-93	Саратов (845)249-38-78	Челябинск (351)202-03-61
Ижевск (3412)26-03-58	Набережные Челны (8552)20-53-41	Севастополь (8692)22-31-93	Череповец (8202)49-02-64
Иркутск (395)279-98-46	Нижний Новгород (831)429-08-12	Симферополь (3652)67-13-56	Ярославль (4852)69-52-93
Россия (495)268-04-70	Киргизия (996)312-96-26-47	Казахстан (7172)727-132	